

North Texas **PC** NEWS

North Texas PC Users Group, Inc.



December 1995
VOLUME 14 • NUMBER 12



North Texas PC NEWS

Published monthly by members of North Texas Personal Computer Users Group for their use. Members each receive a free subscription; for others, price of the NEWS is \$2 per copy. Members are requested to notify the Membership Director in writing of address changes. Send all editorial correspondence to: Editor, North Texas PC NEWS, 218 Virginia Ave., Waxahachie, TX, 75165-2418
Send address changes to: Membership Director, NTPCUG, P.O. Box 780066, Dallas, TX 75378-0066.

Publisher Reagan Andrews (Acting)
(214) 828-0699

Editor Gerry Helne
(214) 938-7268

Assistant Editors Alan Lintel
(214) 220-7829

Doug McCoy
(214) 496-0366

Linda Moore
(214) 342-8833

John Gourd
(214) 783-9829

Newsletter Exchange Lewis Graber

Advertising Director Connie Andrews, (Acting)
(214) 828-0699
Mail all advertising material and ad payments to
North Texas PC NEWS
c/o 3100 Lincoln Plaza
500 North Akard
Dallas, TX 75201-3320

The opinions expressed herein are those of the authors and do not necessarily reflect those of the Group or its members. Copyright © 1995 by North Texas PC NEWS. (Articles without specific copyright notices may be reproduced unchanged by other not-for-profit User Groups if credit is given to the author and the publication.)

Deadline:

All advertising and other material for publication in North Texas PC NEWS must be received by the NEWS staff by the 10th of the month prior to publication. See deadline information below.

Circulation:

North Texas PC NEWS circulation was 2,800 last month. Member distribution was 2,273; remaining copies were distributed to PC user groups at Comdex and around the country, and to advertisers, prospective members and others with common interests.

The editors of North Texas PC NEWS use Microsoft Word for Windows. This issue of North Texas PC NEWS was composed using Corel Ventura 4.2, Corel Draw 5.0, Arts & Letters Express 5.0, Micrografx Picture Publisher 5.0, Adobe Photoshop 3.0 and HP Scanjet IIp. Repro was printed on a HP Laserjet 4M. Principal typefaces include: Palatino, Helvetica, A&L Cafe, French Vogue, Lithos and Mistral.

DEADLINE

Copy deadline for January
North Texas PC NEWS:
Sunday, December 10th

Meeting Dates:

December 18, 1995 - 3rd Saturday
January 13, 1996 - 2nd Saturday
February 10, 1996 - 2nd Saturday



In this Issue . . .

President's Message	2-4
Jim Hoisington	
About Business Cards	4
Reagan Andrews	
SmartSketch by FutureWave. (Review)	5-7
Neal Berkowitz	
InkJet Cartridge Revival	7
Jim Hoisington	
Arts & Letters EXPRESS	8-9
Reagan Andrews	
The Corel Corner	10, 15
JoAnn Elliott	
The Variety Store	11-15
Reagan Andrews	
BBS - On-line	30
Fred Williams	

Special Items:

Agenda, Meetings & Times	1
New Disks from the DOM Squad	18-19
Volunteer Guide	20
SIG Reports	21-29
User-to-User (Help)	31-32
Membership Application	32
Officers & People You should know	33

North Texas PC News

Advertising Prices and Policies

Ad Size	1X	3X	6X	12X
2-Page Spread	\$400	\$325		
Full Page (7 x 9)	225	195	\$165	\$150
Half Page (7 x 4 1/2)	150	125	110	100
Qtr Page (3 1/4 x 4 1/2)	100	80	65	55
Business Card (2 x 3 1/4)	65	50	40	35
Business Card (Members)	35	25	20	20

Reduced rates for multiple insertions of same ad. Require prior commitment in writing and payment in advance (3 months minimum). Copy and mechanical changes requested between insertions will be billed accordingly.

Deadlines: All advertising copy must be received by the PC News staff no later than the 10th day of the month prior to the month of publication unless other arrangements are made with the Publisher. NT PC News publication date is 10 days before the monthly meeting of the North Texas PC Users Group.

Policies & Mechanicals:

- Commercial ads must be in repro form, in final size, ready for printing.
- Halftones must be furnished as final size, screened prints or negatives.
- Halftone screens cannot exceed 100 LPI maximum.
- No ads on front cover. Bleed pages and color must be discussed with Publisher before submission.
- Related ads only; suitability is at discretion of the Publisher and the North Texas PC Users Group Board of Directors.

Payment: Payment in advance of publication.
Make checks payable to: North Texas PC Users Group, Inc.

9:00 AM **Adaptec SCSI Solutions**

Adaptec

Adaptec is synonymous with SCSI solutions for the PC world. Adaptec will be showing its new SCSI products for the PC, including EZ-SCSI 4.0 latest iteration of the premier SCSI installation, configuration and trouble-shooting PC utility. There will be a drawing for free products. *

NTPCUG PROGRAMS & PRESENTATIONS . . .
TIMOTHY CARMICHAEL

10:00 AM **What's New from Broderbund?**

Back by popular demand, Broderbund will be showing their newest interactive, multimedia games for the Christmas season.. May even be a "Sing-Along" if this follows the last Broderbund appearance at NTPCUG. Be sure to listen for Jim Hoisington's sonorous baritone (humming) in the crowd ... There will be a drawing for free products. *

11:00 AM **NTPCUG Business Meeting**

Jim Hoisington, NTPCUG President, et al.

This is the Business Meeting NTPCUG members have been waiting for! We'll have a number of drawings for valuable, and not-so-valuable prizes, and anyone may be the lucky winner of a box of DSDD (360K) 5.25" floppy disks - or Jim's last copy of IBM TopView 1.0. Don't laugh, he swears it's "really fast" running as a shell under Windows 95! There will be a drawing for free products. *

* Tickets for each drawing will be given out from 10 minutes before until 15 minutes after the start-time of the meeting to attending NTPCUG members who show proof of membership.

DECEMBER

SIGs NTPCUG SPECIAL INTEREST GROUP MEETING SCHEDULE

8:00 - 8:55
 Microsoft Networking
 Visual BASIC - Beginning
 MultiMedia

9:00 - 9:55
 DOS
 General Genealogy
 Hardware Solutions
 Internet-Advanced
Introduction to the PC
 Quicken
 StarText
 Visual BASIC
 Windows Applications
 WordPerfect/DOS

9:00 - 10:55
Dallas Corel

10:00 - 10:55
 BASIC - Classic
 (Language)
 CAD

Fox Pro Database
 Graphics
 Networking
 Internet-Beginning
 PAF-Genealogy
 Paradox

Introduction to the PC
 WordPerfect/Windows
 UNIX

11:00 - 11:55
 BASIC Programming
 - Beginning
 Assembly Language
 Brother's Keeper Genealogy
 CAD (Cont.)

11:00 - 11:55 (Cont.)
 Investors
 Graphics (Cont.)
 MS Works
 OS/2 - Q & A
 Roots III/IV - Genealogy
 Spreadsheet Developers
 Windows Developers

11:30 - 11:55
 Orientation

12:00 - 12:55
 Alpha Four
 C++/Advanced C
 Communications
 Delphi
 Desktop Publishing
 Health Care Computing
 OS/2 for End Users
Introduction to the PC
 The Master Genealogist

1:00 - 1:55 (Cont.)
 Business Apps./DAC Easy
 DATAFLEX
 C++/Beginners
 Word for Windows
 OS/2 Developers
Introduction to the PC
 Spreadsheet

2:00 - 2:55
 Advanced Programmers
 QuickBooks
 Application Developers
 (OLE and ODBC)

Please consult the BBS and remember to check the overhead display in the INFOMART lobby for latest SIG schedules and room locations.

1:00 - 1:55
 Access
 ACT!

New Member Emeritus

We have a new Member Emeritus, Timothy Carmichael. Timothy has been Program Chairman since Charles Kroboth turned over the position. And that was a long time ago. Every month Timothy schedules the companies that make presentations in the auditorium. Thank you Timothy for all those years of work. Congratulations.

Business Meeting Drawing

We've got enough accumulated "stuff" that there will be drawings for "stuff" at the December business meeting. Be there! You might win a Borland or Microsoft key chain. If you don't attend, you might win a copy of Topview or dBase II.

Elections are Coming

It is the job of our President-Elect, Andy Oliver, to collect nominations for President-Elect and Board of Directors. Andy is soliciting nominations now. If you know of someone you think would be willing to be nominated, contact Andy.

Membership

Membership was 2,214 at the end of October. I sent out 157 renewal letters for November.

Membership Volunteer Needed

The NTPCUG needs a volunteer to take over managing the membership database. I've done it for a long time and it

has grown to the point that it is like a part-time job. It requires about 10 hours of work a week on the average.

G. KENT COBB SOFTWARE DESIGN AND DEVELOPMENT

P.O. BOX 551271 (214) 343-3554
DALLAS, TEXAS 75355-1271 kentcobb@BIX.com



The ideal volunteer would probably be retired and not be bored with doing clerical work. NTPCUG will furnish the computer and the software. And the system is even documented. As a reward for volunteering, you will be invited to attend the Board of Directors monthly meetings and get the inside story on matters like audio visual problems, insurance coverage, room scheduling and our ongoing problems with the Evil Vice President of DFW Xchange.

Treasurer is Recovering from Surgery

Raymond Reyes is recovering from hip surgery. He called last week to say he was up and about with the assistance of a walker. We wish you a speedy recovery, Raymond.

Mike Firth Resigns

Mike Firth has taken a job that will require him to work Saturdays. Mike currently leads the Classic BASIC SIG and the MS Works SIG. Mike has been involved with personal computer user groups since 1975 and he joined NTPCUG soon after it was formed. Mike has helped out in many ways in addition to leading SIGs. Mike, we'll miss you. Best of luck in your new job.

Another Year

I'm writing this column two weeks before Thanksgiving to meet Reagan's publication deadline. It doesn't quite seem like the holidays yet, but by the time you read this it will be.



New Paradox 7 for Windows 95 and Windows NT

Adapt to your environment effortlessly.

Store a wide range of data types from number, text, date, and time to graphics and multimedia.

Build all levels of business solutions from single-user PC-based applications to LAN-based or client/server applications.

Use OLE Automation and OCX controls to make Paradox work seamlessly with other Windows applications.

View and organize your data with Windows 95-hosted features such as new tab-style controls in the Visual Form Designer.

Create customized forms displaying data from multiple tables with visual design tools—no programming required.

Customize your working environment—see the toolbar how and where you want it.



“What *InfoWorld* has, for a long time, considered to be the hands-down best Windows database... is now more powerful than ever as a development environment.”

—*InfoWorld*, October 16, 1995



Evolution on demand

Paradox® 7 will help your transition to a whole new world. Find out for yourself why *InfoWorld* says, “This is the first Windows 95 application that is improved

enough to be a compelling reason to upgrade from Windows 3.x to Windows 95 and Windows NT.”

What's New

New! Enhanced OLE support lets you categorize, control, manage, store, and share virtually any type of data—including documents, spreadsheets, and graphics.

New! OCX support means that developers can now create applications that use OLE custom controls such as Internet Web browsers, communications packages, or grid and graphing controls that seamlessly integrate with Paradox.

New! More than 100 new ObjectPAL methods give you the most powerful database language available.

New! Object Explorer helps you accomplish more by accessing properties, methods, and events, no matter what your level of expertise.

Unparalleled compatibility

With enhanced Experts and a new Windows 95 look and feel, you'll see the benefits of the new 32-bit technology from day one. Paradox 7 is compatible with previous versions of Paradox for Windows, so any data or applications you created in Paradox for Windows can be used in Paradox 7. You can even share your data with other people who may still be using previous versions of Paradox for Windows on the same network server.

Best suite integration

With new act-alike menus and toolbars, you'll appreciate the seamless integration of Paradox with Novell PerfectOffice 7 and Microsoft Office 95.

Powerful development language

Paradox 7's Integrated Development Environment is unsurpassed. New developer tools such as the enhanced program editor make ObjectPAL™ programming a snap. The editor boosts productivity with features such as color syntax highlighting, block indent, keystroke record and playback, and other tools. Our new high-performance 32-bit Borland® Database Engine (BDE) technology is at the heart of all Borland products. That means when you use Paradox 7, you can access more diverse data faster and easier than with any other database.

Best network solution

If you use Paradox on a network, you'll appreciate its LAN support. With its record-locking capabilities, Paradox allows you to create high-performance network applications, making it your best networkable database choice.

“It is without a doubt a must-have for all serious Paradox users and developers.”

—*InfoWorld*, October 18, 1995

Try Paradox 7 risk-free

If for any reason you're not fully satisfied, simply return it to Borland within 90 days for a full refund.

ORDER PARADOX 7 TODAY

FOR ONLY **\$89⁹⁵***

See your reseller or call today.
1-800-336-6464, ext. 50413

To see the entire *InfoWorld* article,
just access our web site.

Canada: 1-800-461-3327 • Internet: <http://www.borland.com>
CompuServe: GO BORLAND

Borland

Making Development Easier

SmartSketch by FutureWave

by Neal Berkowitz

SmartSketch is a graphics program with a difference. While most graphics programs fit into one of two categories - draw or paint - *SmartSketch* straddles the two genres with features from both. By doing this, *SmartSketch* tries to make itself the one general, all-purpose graphic program for all users. To further promote this end, *SmartSketch* will even install itself into the *Word* and *Excel* button bars making it readily accessible from these programs. Finally, to make itself even more user-friendly, several sets of clip art are provided to simplify several common tasks.

Taking a middle-of-the-road approach to the draw/paint process gives *SmartSketch* a great degree of flexibility. Unfortunately the same process makes *SmartSketch* a bit difficult to use for those familiar with either draw or paint programs.

On the positive side, the program is easy for a beginner to adapt to since most of the drawing processes have a natural feel. It takes a mental shift for the average person to accept that draw programs work only with shapes - you can't just pop down a splat of color. On the other hand, the inability of paint programs to cut and move objects gives other people problems.

SmartSketch has neither of these stumbling blocks. An object can be drawn as a shape and treated as a shape. If a shape is broken into parts, each part still retains the features of the original. For example, a circle can be broken into a set of arcs by drawing a few quick lines through the circle. Each arc, however, still has the curve attributes. The result is that there are no "jaggies" and the arcs can still be pulled based on the underlining curves. Don't like one of the arcs? By using the paint features of the program, part or all of an arc can be erased. The remaining parts still have the attributes of the original circle.

Unfortunately, the combination of paint and draw leads to a few problems. Drawing a line through a circle divides the circle into two arcs. The uniqueness of the circle is partially lost. For those used to overlaying objects, this can be a bit discon-

certing. Likewise, changing the color of an object can produce surprising results. In the aforementioned example, if the line is the same color as the circle, changing the color will affect the line and the circle - just like the average paint program - unlike the typical draw program.



FutureWave stresses this paint/draw fusion in all of their literature and highlights this as the most important feature of *SmartSketch*. Personally, I find that the real value in the program is the attention spent on their clip art collections. These collections focus on the strengths of the program and improve the usability of the program tremendously. Both line art and colored images of the collections are available with only a single click needed to change from one to the other.

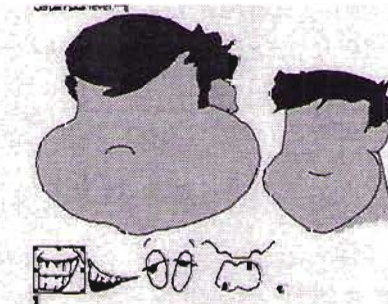

The first of these collections is a set of cartoon faces perfect for newsletters or personal writings. Unlike most collections of clip art, *SmartSketch* gives the user the outline of faces and bodies, then lets the user select the desired mouths, eyes, noses, and so forth. The result is that the images the user selects are not just cookie-cutter pictures that one can find everywhere. The pictures are custom enough to look unique. *SmartSketch*

has found a good balance between stock images - which require little skill but have no originality - and custom drawings - which are unique but which require a certain skill level.

WAY TO GO
T R A V E L
Member of NTPCUG

Debra Green

903 N. Bowser • Suite 100 • Richardson, Texas 75081
(214) 234-4590 • 800-652-9229 (9302)

SMART SKETCH ... Ctd.

With SmartSketch, just select the outline wanted, add facial features, tweak these features with the paint and draw tools, and you are done. The time required to do this is minimal, you don't need a lot of artistic ability, and the results are good.

The second collection of clip art is the standard animals, objects, people, and what not. Once again, one of the great features of the collection is the ability to modify the objects to suit your personal needs. So what if the dog image is the wrong color or needs a longer tail. It only takes a few seconds to make the changes.

The remaining collections are even more interesting. The collection of home design makes this program a basic home layout and remodeling tool. A collection of beds, tables, chairs, and other furnishings are paired with home hardware features to let the user design both a building and the contents. The process does not have all the fine details of a true home design program and measurements are nonexistent, but for basic work, the program is nice.

Another collection is reminiscent of the old paper dolls or Colorforms. With Colorforms a person would take plastic cut-out clothing and apply it to an underwear-clad drawing on the pad. In the SmartSketch equivalent, the user selects the image of the person. The user can select from an extensive set of pants, shirts, dresses, coats, and accessories to clothe their figure. If one of the out-

fits is the wrong color, a few quick modifications can make the desired changes.

The process is easy enough for the younger kids to follow. Unfortunately, it is also easy to make mistakes and modify something differently than what is really wanted. I had to make constant use of the undo feature. The figures of the men and women are not interchangeable poses, so the older kids will have a bit of a challenge to put the women's clothes on the men's figures.

A final feature that attracted my attention was the way libraries of images are maintained. Smart-

Sketch uses a tab bar with labeled tabs to take the user to the desired page of clip art. This tabbed page concept is extremely easy to use and is fast. It is a great deal easier to use than a book of images, a monster page of all images, or a portfolio or reduced-size drawings. The tabs are so easy to use that FutureWave used a tabbed library as its tutorial.

Overall, SmartSketch is an interesting product. For those unfamiliar with draw and paint programs, its idiosyncrasies will not present any stumbling blocks in the unlearning

process. The clip art and ease of interfacing with Word and Excel makes this a good "quick and dirty" tool to add pizzazz to writings. The only people who will have trouble with SmartSketch are those already comfortable with draw and paint programs. The number of concepts needed to be unlearned are significant enough to make this program frustrating at times. For beginners this program is very good; for experienced users, stick to your current tools.

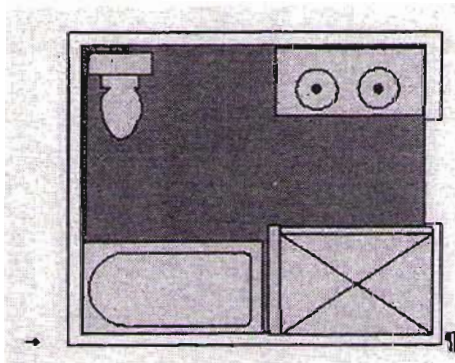

PCs

K.B. Barton
President

PC Services & Solutions, Inc.
Software/Network Professionals

7046 Azalea Lane
Suite 100
Dallas, Texas 75230

214 - 750-3662
Fax: 214 - 750-3664
Pgr: 214 - 805-5951
Internet: kbarton@pcssi.com



Peak Performers, Inc.
Job Placement & Recruiting Specialist

GENE McCORMICK

P.O. Box 92965 Southlake, Texas 76092
Phone (metro) 817-424-5185 Fax (metro) 817-424-5186

Inkjet Cartridge Revival

Reviving your gunked up HP 51626A high-capacity inkjet cartridges can save money. Those are the ones used on the H-P *Deskjet*, *Deskjet plus*, *Deskjet 500*, and who knows what else. One of the refiller vendors recommended an easy, low-tech method which I tried with great success. At 27 bucks a pop for new cartridges, there is an incentive.

1. Fill an empty, *clean* tuna can with 1/4 inch of distilled water. (It is immaterial whether this was dolphin-free tuna grin.)
2. Heat it to boiling on a stove-top burner.
3. Grasping your 51626A cartridge with some long pliers, so you don't burn your fingers, dip about 1/8 inch of the nozzle end of the cartridge in the boiling water for about 30 seconds to a minute.
4. Remove and dry off the cartridge by gently patting with a paper towel. (You don't want it to dribble on your printer's electronics, trust me.)

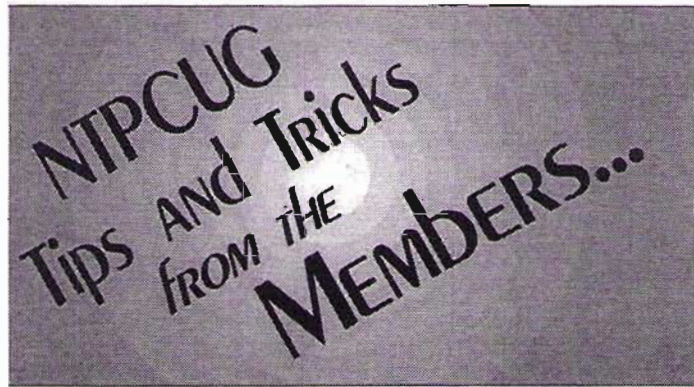

5. Insert in your HP printer and run the self-test print pattern (the one that begins with the diagonal line pattern, so you can see exactly which nozzle holes are still plugged). Number this test run so you can monitor your progress. There will probably be some nozzles still plugged, so go back to step #2 and repeat the sequence until most or all the nozzles flow cleanly during the print test. If you are only printing straight text, you can ignore a few of the extreme end nozzles that are only used in larger graphic printing.

This method has worked nicely for me. You may have to repeat the boiling 10 to 15 times (really rough guess) depending on how bad the gunk-up is. I was amazed to find that the H-P cartridge innards were easily tough enough to stand the boiling.

Hey, this is a great technological advance if you can spend the TIME. Take that from a guy who built his own dot matrix ribbon re-inker from a 1950s record player.

Lewis Graber

SMART SKETCH ... Ctd.

General Info:

SmartSketch by FutureWave Software. Suggested list price \$69.95. Available directly from FutureWave for \$49.95. A trial version is available for \$5.95. Call FutureWave at 1-800-6193 for more information.

Neal Berkowitz

Call 214.746.4710 to register for your

FREE ISDN SEMINARS

Space Is Limited. Call Today.

The INTERNET and ISDN will CHANGE THE WAY YOU DO BUSINESS

- **Introduction to the Internet and ISDN**
This seminar will explain and demonstrate, in non-technical language, the profound ways in which the Internet and ISDN are changing business today.
- **Advanced ISDN Connectivity**
A more technical insight into the new breed of Internetworking applications that ISDN makes possible. This seminar will explain the ISDN protocol and demonstrate current ISDN products and services.

ONRAMP
TECHNOLOGY

INFOMART • Voice: 214.746.4710 • Fax: 214.713.5400
Fax Back: 214.746.4852 • E-Mail: info@onramp.net

Arts & Letters EXPRESS Easy, Fast & Powerful

My favorite graphics editor is the latest evolution of my first graphics editor. In fact, most of the "art" used in the *PC News* comes directly from the screen(s) of *Arts & Letters EXPRESS*. The newest version is several magnitudes faster than the original *Arts & Letters Editor* I acquired in 1989 and defies current trends in Windows software which tend to be slower and clumsier than earlier versions.

During the grizzly days of *Windows 2.xx* (1989) I acquiesced to a "suggestion" from (then) *PC News* Publisher John Pribyl and agreed to review several of the (then) available "art" packages for the newsletter. First I received was the A&L editor.

That's when I fell in love with *Arts & Letters Editor 2.0* which would run on an 8088-powered PC. For some reason, A&L seemed then to fit my style of use better than the other editors. *EXPRESS* still does. I don't mean to denigrate either *Designer* or *CorelDRAW* — both are highly capable in the hands of an expert (I'm not) and have advanced features I'll never have the time to learn.

Guess that's the reason for this review of the latest A&L iteration, the power a well-designed product has to make things easy for the user and attractive for the viewer. *EXPRESS* certainly fits that description for my purposes.

Saw it last year at Comdex. I was fascinated watching it run through its paces in the Hitachi booth at LVCC by a skilled user. I was particularly interested in its handling of colors, tints and shades, and by the ease of "advanced" features implementation. Also appreciated the improved UNDO facility since I tend to need that quite a bit.

Phoned Computer Support Corp. (661-8960) and asked for the upgrade to my (then) version, *Arts & Letters Editor 3.12*. CD-ROM arrived some time later and was very "light" to the feel. Reason for that was minimal documentation. More comprehensive documentation (250 pages) can be printed

from the CD-ROM if the user wishes, but I've been able to find what I need from either the HELP or tutorials and never got around to printing it out.

Computer Support (A&L's publisher) states minimum requirements are 386SX, 4 M ram, mouse or other pointing device, CD-ROM drive and *Windows 3.1* or higher. It will run fine in *Windows 95*.

Installation from the CD-ROM was quick and flawless in both Win 3.11 and Win 95. It loaded and ran well from a DriveSpace 3 volume. User is given the option of a full installation to the hard disk (approx. 65 M), minimal, i.e., disk and CD, (12M), or "bare bones" running primarily from the CD-ROM which takes only 42 K of disk space.

Most impressive feature in the new *EXPRESS* is the greatly enhanced handling of color. A&L obviously spent a lot of time looking at this aspect and made working with 24-bit color, hue, brightness and contrast as easy and rapid as possible. I appreciated addition of 15 color palettes and serious color-control filters including ability to reduce the image to monochrome (grays) which allows user to see how image will appear on monochrome printers.

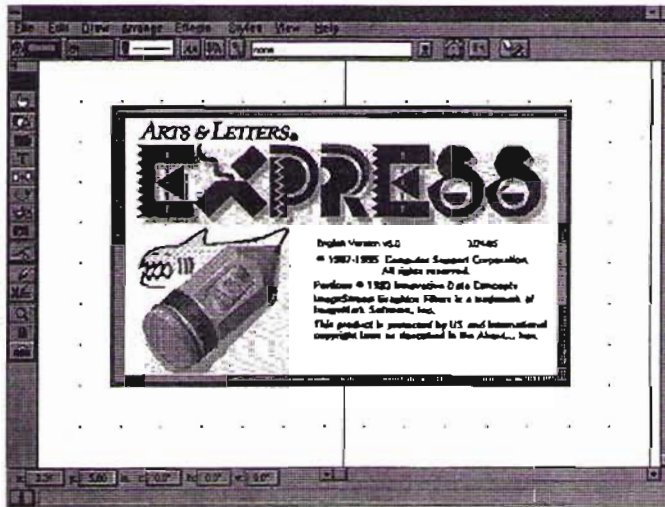

This extends to the object fills area as well. This has been significantly improved in terms of flexibility and ease of implementation and includes a palette of fill combinations to make things even easier for the new user. Both radial and linear fills are quickly accomplished as a result. My only complaint here is that the smooth gradient fills on screen are never reproduced by the laser printer.

This not A&L's problem, but also afflicts *CorelDRAW* fills as well and is a major problem with the combination of Windows and the H-P 4M printer, and is one of the reasons I usually suggest other platforms for serious work. When I go from an *EXPRESS* PostScript file to film output in an Imagesetter or Linotronics, this isn't a problem.

EXPRESS includes the usual object manipulation features, perspective, warp, extrusion, text to path editing (including some pre-set text-path ob-

ARTS & LETTERS EXPRESS ... Ctd.

jects) and others. I can't think of any effect the artist could imagine that couldn't be accomplished in EXPRESS.

Text handling is on a par with other graphics editors, which means it's occasionally clumsy and difficult to manage when importing large blocks of text into an art layout. This is one area where both *Designer* and *CorelDRAW* may have an advantage over EXPRESS. However, I really don't like any of them in this regard and frequently resort to handling text via page-layout software and bringing the "art" over instead.

A&L's 91 type faces included with the EXPRESS CD aren't as numerous as some other packages, but are very nicely done and should cover most users' potential needs. You see several of them in the *PC News* each month since I use the package to make the column headers that appear in the newsletter. However, when the user registers the package, they can expect a CD-ROM from Computer Support containing approximately 1,000 Type 1 (PostScript) and TrueType fonts to arrive in the mail.

All of the A&L, Type 1 and TrueType outline fonts can be edited and manipulated in EXPRESS to create new, individualized fonts if the user wishes.

A&L improved its import capabilities and now can bring in EPS, CDR, CGM, DRW, PIC, TIF, TXT and WMF files. Still can't handle PCX or BMP files, but I can convert just about any bitmap file format in *Micrografx Picture Publisher 5.0* into a format A&L recognizes. Users can export in EPS (AI and "standard"), CGM, TIF, SCD, WMF and WPG formats. EXPRESS also has added bitmap image enhancement (primarily TIF files) for improved screen presentation.

Clip art has always been one of A&L's strongest features. Users receive approx. 10,000 clip art images with EXPRESS, all of which can be modified, broken into individual components and easily incorporated into other images. A very good clip



art manager with thumbnail display images is included which facilitates selection and retrieval of desired images. It could use a little improvement such as allowing multiple image selection and retrieval (it may already, and I just haven't discovered how) instead of forcing the user to go back to the menu again and again.

I did a "quick and dirty" *Ex Libris* label for our ever-growing book collection as an example for this review. Started with a filled rectangle and changed the fill color to black. Then scanned my latest photo into a TIF file, took it to *Picture Publisher* and converted it to a high-contrast "line" image and imported the finished image into EXPRESS. Added a text message (in white type) and exported the image as an EPS file (shown here). Entire exercise took about 15 minutes.

Obviously, I'm very biased in this review. But, I do think most users who need to produce "occasional art" would find EXPRESS intuitive and easy to use. It's also capable of the most demanding graphics tasks and certainly would meet the needs of a professional artist. *Arts & Letters EXPRESS* is available locally through retail vendors and through Computer Support Corp. (214) 661-8960.

Reagan Andrews

EX LIBRIS
Reagan & Connie
Andrews



Corel 6 Bug List

I downloaded a Corel Bug list from the Internet. Below are three of the problems with solutions that you may find helpful. If you want the whole file, log onto the NTPCUG (phone numbers inside back cover) and enter the Applications/Corel Group, and read messages. If you do find any new reproducible problems and "workarounds" let me know and I'll report it to Corel.

"If you want to publish this list, you are welcome to, with the sole condition of maintaining the initial general concept and reporting back problems and workaround contributions in the following format:

PROBLEM 6.XXX: Your own description of a problem verified in another thread.

STEPS: If necessary, a description of how to duplicate it.

IMPORTANT COREL ADDRESSES & PHONE NUMBERS

Corel Corporation
1600 Carling Avenue,
Ottawa, Ontario, Canada
K1Z 8R7

- ◆ Technical Support Representatives800-818-1848
- ◆ F Release, CD-Rom only (latest "fixes" and patches for Corel products)800-772-6735
- ◆ Customer Service Representatives800-772-6735
- ◆ IVAN (Interactive Voice Answering Network)613-728-1990
- ◆ 24 Hour Automated Fax System 613-728-0826 Ext.3080
- ◆ Technical Support hours are 4AM to 8PM (EST) excluding holidays
- ◆ To obtain our catalogue please request document #2000



WORKAROUNDS: Ways to avoid it, revert damage caused by it, make it go away.

STATUS: Date entered the list, info about Corel's position (if any)."

Jose Camara
CompuServe: 71302,3551
Last Update: November 7

PROBLEM 6.003: Saving from Draw 6 in version 5 format generates corrupt file.

STEPS: In 6, save in version 5 format. Open in 5. Save it. Won't open again.

WORKAROUNDS: After opening the file saved by 6 in 5, bring up the styles roll-up and load a new *.cdt style sheet. Saving won't corrupt the file now. If you didn't see this before and already have work lost in an unreadable file, use a binary editor like XTree or Norton DE, look for the string 'stlt' and replace it with four binary zeroes. After opening, replace the style sheet.

STATUS: Listed since 9/7, reported as fixed for the December patch.

PROBLEM 6.006: 3D rotate filter in Paint 6 generates 'PICOR60: error in filter op.'

STEPS: Open new image, 360 x 504, 24 bit. Apply 3D rotation, -70H -43V, 'best fit'.

Click on preview. Error msg comes up.

WORKAROUNDS: Use slightly different angles, only a few combinations give the problem. Simply don't use preview, actual filter operation works.

STATUS: Listed since 9/7, reported to Corel

PROBLEM 6.014: Page sizes accept only two decimals, can't enter 3-7/8 in., for instance in Draw! 6.

STEPS: Enter 3.875, will be truncated to 3.8700. Where is 0.1 micron precision?

WORKAROUNDS: For 3 7/8 in., change units to points and enter 279 (72 'points'=1 inch).

STATUS: Listed since 9/13, reported to Corel.

Product Updates!

In addition to these new products, Corel is updating CorelDRAW 5 to run seamlessly under Windows 95. A single

Continued on page 15 ...





The Best, the Good, the Bad and the Voracious — Comdex/FALL '95 brings out best and worst In vendors, Merry Marketeers and APCUG in Vegas

Internet, Multimedia and JAVA flood the floors ...

Can you say "Multimedia," "Internet" and "JAVA" ten times in a row really fast? Add "Windows 95" and "Windows NT" really loud? Then, whisper (really low) "OS/2" and finish by turning your back and mouthing (without saying it out loud) "UNIX?"

I can't either, but that's Comdex/FALL '95 we saw/heard on the convention floors.

If you got the idea from the above that software dominated Comdex and was essentially a Microsoft (and SUN in spite of their absence from the floors) show this year, you're correct. Was it as exciting as usual as a result?

With one exception, No. Even the normally (and terminally) "perky" folks demonstrating the various software products didn't seem that excited this year. That was especially true at Novell (WordPerfect) where a pall of uncertainty seemed to dampen normally boisterous and very loud spirits.

COMDEX AT THREE ... MAYBE, FOUR SITES

Comdex was "only" at three (maybe four) sites in Las Vegas. Main site was the Las Vegas Convention Center (LVCC), followed closely by the Sands Convention Center (SCC), with the formerly-premium site at the Las Vegas Hilton show area coming in third.

Gone are the days of hustling and mad scrambles to make all six - nine show sites scattered around Las Vegas.

The "maybe" fourth site was the Sahara-based Adultdex site that housed the XXX, erotic CD-ROM display area. Softbank "excluded" these vendors for Comdex/FALL '95, so several got together and staged a "rump"* show of their own at the Sahara.

Yes, I did go to the Sahara. Yes there are some humorous aspects I'll mention later as well as a question or two about this.

* Rump here is not a play on words, but is used in the political sense as in a 'rump convention.'

THE REAL COMDEX — AND COMING ON-LINE WAR

Real Comdex battle was joined at the Hilton display area where AOL (America On Line), CompuServe, Prodigy, Netscape and about a bazillion Internet service providers (ISP's) held forth. This was Comdex at its best with enthusiasm, spirited interactions and some not-so-subtle differences in approach to the rest of the show.

Show "mannequins" were invisible here and people manning the booths were very technologically savvy. Saw lots of long hair, earrings and extremely casual dress. Didn't see a preponderance of merry marketeers or "empty suits" at these displays.

MSN wasn't there — Microsoft had them at its huge pavilion at LVCC. There were crowds at the Microsoft site, but I'd have preferred seeing MSN at the Hilton area competing with the others.

NUMBERS IN QUESTION — EVEN COMDEX/FALL CAN'T BE ALL THINGS ...

Comdex tries to be all things to all people. Just can't be done, and this year's show proved it if nothing else. Show and APCUG (Association of PC Users Groups) raised a lot of questions for me, and maybe for others as well. Always does, so that's nothing different.

THE VARIETY STORE

From the top are the numbers. Comdex (Softbank) will be claiming crowds that simply weren't seen this year. That's nothing new, Interface did it for years. Best clue was absence of long cab lines after Tuesday, Day #2 of the show. Perhaps better, were the filled boxes of attendee badges that were still around at show's end. Softbank is probably counting show registrations — not actual number of people who came to Las Vegas.

Missing (or semi-missing) on show floors this year were an increasing number of vendors usually associated with the big show in the past. At top of the list were Intel, again, Compaq, again, and Sun Microsystems, again. Intel was only "half-missing" since they did have a multimedia, *Pentium* show in the main corridor at the Las Vegas Convention Center — but no booth(s) on the show floor.

APCUG HOSTED THE 'BEST,' 'GOOD' AND 'VORACIOUS' ASPECTS OF COMDEX FOR '95

APCUG (Association of PC Users Groups) is a major focus of my Comdex activities, and provides a substantial forum for PCUG's and vendors alike. APCUG arranges a series of breakfasts, luncheon presentations and evening "receptions" during Comdex which are sponsored by major vendors. This provides opportunities for PCUG officers to hear what these companies and their officers think about the PC's fu-

ture and their plans to accommodate this growth.

Vendors get the opportunity to address 300 - 400 PCUG officers, decision makers and major influencers (don't know if that's a real word, or just *marketing-speak*) representing thousands of end users and customers. Some vendors do this very, very well and recognize the impact of their efforts.

Other vendors, joined by Microsoft this year, don't. Sprinkled among the excellent presentations and interchanges between PCUG officers and vendor managers/officers, were some of the most appalling abuses of marketing I've ever had the misfortune to sit through or witness.

These vendors may be taking their cues from the behavior of far too many APCUG attendees.

Humor, gallows-type, did permeate the vendor events — with exception of the Novell presentation — when each of the respective CEO's was asked by WordPerfect users/fans/survivors if they wouldn't like to buy WordPerfect after Novell announced it was for sale.

Met with a lot of laughter, but no takers among the vendors.

SYMANTEC "SHINES" WITH GOOD CITIZENSHIP & CEO EUBANKS' CANDOR, VIEWS

Symantec is firmly in "Best" category as far as Comdex and APCUG events go. Seems that Symantec assisted in getting

some of the efforts at the Oklahoma City, OK, disaster sites on-line and functional at the request of the members of the Oklahoma City PCUG. Didn't hear about this until the end of a very good presentation by Gordon Eubanks, Symantec CEO, candidly describing his views of the coming year for the PC community.

The APCUG crowd (approx. 400) gave him a standing ovation when he was presented with a commemorative award by John Brewer, OKCPCUG, for Symantec's efforts in Oklahoma City following the bombing of the Federal Building. This was followed closely by a similar presentation by Dick Kellerman, President of the Tampa Bay Computer Society, for Symantec's assistance in helping outfit PC's for patients at the Tampa Bay, FL, VA Medical Center Spinal Cord Injury unit.

Eubanks was clearly touched by the awards, but stressed that "it wasn't him," but came through the efforts of Symantec's User Group Coordinators.

BORLAND — A CLOSE "SECOND" AS WETSEL DESCRIBES FUTURE IN THURSDAY PRESENTATION

Borland's annual Thursday morning breakfast for APCUG officers has traditionally been a major highlight for PC users groups officers at Comdex. Borland was different this year. Gary Wetsel, Borland CEO, addressed the gathered PCUG officers with candor and a description of Borland's retrenchment to its strengths in development and programming tools. Breakfast was at the Stardust Casino Ballroom, Philippe Kahn wasn't there and there was no *professional* entertainment.

In the past, Borland has staged this Las Vegas-style event at Caesar's Palace and included professional, Las Vegas show entertainers as part of the affair, usually followed by Philippe Kahn talking about Borland and his views of the PC future.

It was a lot of fun in the past, but this year the "Spartan-like" presentation had an air of enthusiasm and communication that would have been lost in the glamour of previous presentations. Instead of entertainment, we received real information and a combatant's view of the revival of a great company.

ADAPTEC, LOTUS DELIRINA AND COREL KNOW THE GAME ...

Events staged/presented by Adaptec, Adobe, Lotus, Delrina and Corel were examples of good showmanship and information transfer at APCUG meetings. Adaptec and Corel were represented by their respective CEO's and focused on the state of the PC "art" while Adobe, Delrina and Lotus demonstrated an affinity for good or excellent product presentations that were both informative and sensitive to the needs of PCUG's.

Only problem with the latter was cumulative time spent "in the dark" while viewing product presentations. Lotus managed this by coming early in the day on Monday, November 13, before everyone was exhausted and tired of this, while Delrina was represented by Hartley Macklin, a long-time member of APCUG who had a good feel for the people watching the demonstration.



MICROSOFT DISAPPOINTING AS 'RECEPTION' BECAME WORST KIND OF 'MARKETING'

Microsoft was most disappointing of all at Comdex. MS has traditionally hosted a reception after the APCUG Summit that has featured Bill Gates, MS product line managers and other MS executives in a reception focused on casual interactions with APCUG members and MS people.

NOT THIS YEAR.

Apparently, some very eager MS marketing people decided this was one more opportunity for APCUG people to sit in the dark and hear a machine-gun-like sales spiel from one more "talking head." During the Q&A period after the 90 minute fiasco on *Blackbird*, Microsoft's response to SUN's *JAVA*, several APCUG members who had asked questions realized they hadn't been answered, but had been smothered in a dense fog of *marketing-speak*.

I mentioned this to one of the MS "perky people" hanging around the crowd — and got more of the same. Don't think I'll make that mistake again.

USED AND ABUSED?

Sorry, Microsoft, 90 minutes listening to rapid-fire verbalizations isn't a "reception." Sat there thinking that Microsoft had decided the PCUG's weren't worth the trouble since their *Windows 95* beta was finished ... Also regretted missing the NEC/MIPS and MSI receptions/parties to do so.

LOOKING FROM OTHER SIDE, I UNDERSTAND THE VENDORS' APPROACH TO APCUG ...

I don't think the vendors are solely responsible for this turn. I've been watching APCUG functions at Comdex for several years and have discovered I don't like what I've seen lately. Far too many attendees were almost rapacious in their quest for free meals and free software. Very few paused to consider how much the vendors were paying to present these forums.

Although I've used the description of "sharks at a feeding frenzy" to describe some members of the legal community in the past, as well as "ravening hordes," these could be used just as easily at APCUG events to describe PCUG officers approaching the buffet lines and product hand-outs. I don't exclude myself in retrospect.

Difference is that I do know better and can feel some shame for this behavior in myself and others I'm associated with at these gatherings.

PC HARDWARE TOOK SECOND PLACE AT COMDEX /FALL '95

At the hardware end, IBM/Motorola/Apple had huge booths on the floors pushing the consortium's *Power PC*-powered products, but still fell short of Microsoft's show impact. Richardson-based Cyrix followed closely by AMD and NexGen affirmed that x86 isn't "dead" and were all demon-

THE VARIETY STORE

strating 5x86's and 6x86's in their displays.

NEC devoted a lot of space to the MIPS R-10000 and R-4000 RISC CPU's and DEC was showing their Alpha series of 275 and 330 MHz CPU's. With exception of Apple, all the RISC-based machines were running *Windows NT*. Motorola and IBM were running *AIX* on their machines as well as *NT*.

'BARE-BONES' MOTHERBOARDS NOT AS ABUNDANT AT COMDEX ASPEN SYSTEMS WAS DIFFERENT

Comdex used to be known for hardware vendors, particularly off-shore motherboard and PC vendors offering "show specials" consisting of motherboards, CPU's and support chips at prices typical of those seen locally at "First Saturday" and in the Vendor Showcase in the basement at Infomart during meetings. Not so, this year — with an exception from Aspen Systems.

Did see one "bare-bones" motherboard that was interesting in the Sands. Aspen Systems was showing a motherboard, CPU and special power supply that got some attention. Reason was the 330 MHz, DEC "Alpha" CPU shown running *Windows NT* at their booth. You really don't want to know the price of this "bare-bones" system since it's well into four figures.

It was very impressive and I suggested to Connie it would make an excellent "stocking

stuffer" which failed to result in a (printable) comment.

CONNER A PLEASANT SURPRISE IN PRIVATE DISPLAY/SUITE AT DI

Looked for Conner Peripherals on the Comdex ShowGuide since I wanted to follow up on my review of the Tape.Stor 4000. Conner was listed as having a booth, but no booth was located where the guide indicated. Arcada Software was at Comdex, in the North Hall, and reported that Conner had a private suite at the Desert Inn.

Visited Conner's suite and saw the new Conner tape drives, including the Tape.Stor 8000 drive based on the Travan (TR4) tapes that will be available in the first quarter of 1996. Drive is nothing short of amazing — stores eight (8) Gigabytes compressed and four (4) Gi-

gabytes in "native" mode on the new QIC 3095 Travan tapes. Also reported to be somewhat faster (is that possible?) than the Tape-Stor 4000 and can read the earlier-generation QIC tapes as well.

In the process got a gentle, friendly and informative reminder of the realities of hard disks and tape drives in a commodity market by Mark Seither, Conner's Manager of Public Relations. I needed the reminder, since I'd been thinking "ultimate" PC's rather than "real" PC's needed in the marketplace. What struck me later was fact that I felt I had received some valuable education, not a "marketing" pitch. That's professionalism.

SOME PC MARKETING NEITHER 'QUIET' NOR 'GENTLE' AT POWER PC

Said "whisper" OS/2 in the introduction to this piece, but didn't suggest going into the *Power PC* Pavilion. Noise level *outside* the actual theater area in the pavilion must have been at least 110 -125 dB. If the *Power PC* presenters weren't wearing hearing protectors, am sure they sustained at least some high-frequency hearing loss they'll discover down the road as a result.

A 'killer' give-away

IBM/Apple/Motorola did come up with a "killer" give-away idea, though. Just for entering the pavilion, they handed out a black "dongle" Comdex attendees could use instead of the cheapo plastic convention badge holders.

"Traditional" badge holders worked OK, but the badges often fell out when you bent over, etc., and lost badges have



The 'magic,' IBM Power PC dongle was a life-saver at Comdex/FALL 95

been a problem at every Comdex (and any other trade shows) I've attended.

In addition to securing the badge, the "dongle" had pockets for business cards to hand out, and zippered pockets for business cards received.

A simple, but very useful and thoughtful item that advertised the *Power PC* very broadly at this year's Comdex.

XXX 'Adultdex' Had own surprises At Comdex 'rump'

Said I'd visited the *Adultdex* 'rump' show after vendors of XXX and erotic CD-ROMS were ousted by Softbank this year. Also talked with one of the alternate shows' founders, Mark Brown, Publisher of the *Interactive Quarterly* who pointed out that adult CD-ROM vendors had pioneered much of the video and interactive technology being seen at Comdex-proper.

Adultdex site itself was subdued, quiet and well-attended — a significant change from the rowdy, loud and chaotic situation at the Sands Convention Center basement last year where vendors were located.

Didn't see anything at display area that couldn't have been found at Dallas' "First Saturday." Except, videos were on open display on large monitors and projection screens throughout the area. Did notice a tremendous variability in video and sound quality with some of the material on display.

ALONE AMONG THE VIDEOS ... HARDWARE?

Was a real surprise when I ran across a 'lone' hardware vendor



among the sex-oriented *Adultdex* booths at the Sahara Casino Convention Center.

Dealing in dot-matrix and laser printer parts and printers, the vendor remarked that his was a relatively small operation, and he thought he was making more contacts and doing better business at the Sahara than he would have at one of the "real" Comdex sites where he would

have been surrounded by bigger, showier and louder vendors' booths.

He also mentioned fact that the space was much less expensive than that quoted by Softbank at Comdex-proper.

Reagan

CD-ROM with updates that fix problems encountered using Windows 95 is available free to CorelDRAW 5 customers. To order, customers can call 1-800-772-6735 in North America or 011 353 1 706 3912 in Ireland. A maintenance release for *CorelDRAW 6* is currently in development and scheduled to ship in early December. The maintenance CD-ROM corrects outstanding problems found in revision 6.00.118 and adds enhanced functionality to several of the modules in Corel's flagship product. This update is also free of charge and available directly from Corel and its service and support providers worldwide.

Beta Testers!

For any user group members interested in beta testing Corel software products, please call Corel's faxback system at 613-728-0826 ext. 3080. Request document #1006.

How to Reach Corel!

In addition to reaching us Corel CompuServe Corel invites you to visit the CorelNET forum on



the World Wide Web. To access CorelNET just type <http://www.corelnet.com>. Group meetings may now be posted in the User Group area of CorelNET. Realtime chat software has now been added to allow user group members to meet online. Corel Corporation also has a site available to all users direct from Corel. To access type <http://www.corel.ca>.

Michael Bellefeuille
User Programs Manager, ext. 1266

CServe: 73173,462
Internet: mikeb@corel.ca

Kimberley Prince
User Programs Coordinator,
ext. 1006
CServe: 75674,2535
Internet: kimp@corel.ca

JoAnn Elliott

Internet: joanne@scout.cor.net
CServe: 74471,3705
AOL: JoAnnE3160



ADA UPGRADE

Portable Upgrades



NEW!

Introducing the AIRport™ 2000 kit, for quick, wireless infrared file transfer and synchronization between notebooks and desktop PCs. Now updating your files can be as easy as changing TV channels with a remote control.



For PCMCIA connectivity, the 16-bit SlimSCSI™ kit is the best way to take advantage of the fastest portable peripheral connection—up to 2MB per second. It's complete with a 3 foot cable and Adaptec® EZ-SCSI™ software.



Upgrade your portable with up to seven SCSI peripherals via the parallel printer port with the MiniSCSI™ Plus kit. Or for data transfer rates of up to 1 MB/sec upgrade with the MiniSCSI EPP (Enhanced Parallel Port) adapter.

Desktop Upgrades



The Adaptec TotalConnect™ kit, with the AVA™-1515 host adapter, is an affordable solution for single users or small offices needing connection to a wide variety of SCSI peripherals—up to seven.



The TotalCD™ kit, with the AVA-1505 host adapter, is an affordable solution for users who simply want to upgrade to virtually any Fast SCSI-2 CD-ROM drive. For both internal and external CD-ROM drives.



The SCSI Direction™ kit with the AHA™-1522 SCSI host adapter connects up to seven SCSI-2 devices. Including audio, data and photo CD-ROM, removable media, magneto-optical, hard drives and scanners. All on one I/O slot.

SCSI delivers a wide range of peripherals.

For over a decade SCSI has been the performance I/O choice on the PC. And now it is becoming the easiest way to upgrade. With SCSI, adding peripherals is quick and easy. Just plug in the peripheral and install the related software. SCSI can support up to seven peripheral devices and is compatible with all current application software and DOS, Windows® 95, Windows NT™ or OS/2®.



The key to easy upgrades is SCSI !!!

"The wave of new standards and specifications hitting the market is unlike anything we've seen in the past... we have to be much more careful in selecting our next computers because this confusion will affect a system's upgrade potential...you're probably going to have trouble trying to add a second hard disk to that system you just bought..."

John C. Dvorak,



PTEC

REPORT 1996



Performance Upgrades

The SCSI Master™ kit, with the AHA-1542CP card, is the hero of all SCSI host adapters for virtually any ISA PC. It delivers high overall system performance for multitasking operating systems like Windows 95 and OS/2 Warp.



This Adaptec PCI SCSI Master™ has already improved the performance of over one million PCI/Pentium-based PCs. With our PhaseEngine® RJSC processor you'll be reaching transfer rates faster than a speeding bullet.



The PCI Ultra Wide SCSI Master™ kit is the fastest SCSI ever! Use it now for super fast PCI performance. And, when you upgrade to UltraSCSI peripherals, you'll be doubling the transfer rates and the bandwidth. For four times the I/O muscle.



Build a Better Server

The AHA-3940 card unleashes server I/O performance with PCI multichannel SCSI. With two I/O channels, data transfer burst rates can reach up to 133 MB/sec. Each channel is powered by its own PhaseEngine® RJSC processor to optimize performance and response.



Now that you're leaping buildings in a single bound, you're ready for remote SCSI management. Adaptec CIO™ software remotely monitors and manages SCSI peripherals from any Windows® desktop. So you can keep track of the server down the hall, or across the world.



Until now RAID 5 was too pricey for smaller sized LANs. That's why we introduced the AHA-3985 RAID adapter. Our unique design eliminates the need for the costly microprocessors and memory of conventional RAID controllers—without sacrificing performance.



It's amazing how well things work.

The good news is that since Adaptec promoted ASPI and something called Adaptec EZ-SCSI software you can make SCSI work without a hassle...I'd advise adding an Adaptec PCI Master kit. You should be able to string 7 external SCSI-2 devices to this thing effortlessly, just as if you had a Mac.*†

July 1995 PC Magazine



How to Buy:

You have a choice. So ask your dealer for a SCSI peripheral. Whether you're buying scanners, high-capacity hard drives, CD-ROM drives or tape drives. CD-recordables, magneto opticals, or removable media drives. External or internal. Make sure it's a SCSI peripheral.

To find out where to buy, for product information, or to find out more about SCSI, step into the nearest phone booth and call 1-800-804-8886 ext. 1839 now. For faxed information dial 1-408-945-2570*. Or perhaps you would prefer to read about your favorite super hero while you surf the net. To visit our home page type <http://www.adaptec.com>



I/O NOW MORE IMPORTANT THAN EVER.

MiniSCSI, TotalConnect, TotalQD, PhaseEngine, SCSI Direction, SCSI Master, PCI SCSI Master, Adaptec CIO, EZ-SCSI, AHA, and AHA are trademarks of Adaptec, Inc. which may be registered in some jurisdictions. Windows 95 is a registered trademark of the Microsoft Corporation in the U.S. and other countries, used under license. All other trademarks used belong to their respective owners. *† Reprinted with permission from "PC Magazine" July 1995/1995 Ziff-Davis Publishing Company.

Disks of the Month for November

Note: All of these disks are distributed on 1.44M disk only

Disk 1015. Drag And File 95, – Windows 95 File Manager and Viewer by Dan Baumbach, Canyon Software, 1537 Fourth St., Suite 131, San Rafael, CA 94901. (800) 280-3691 Shareware Fee: \$35.00.

Drag And File streamlines and simplifies the work of managing files under Windows 95 and Windows NT. It offers several unique functions, such as a directory finder, a duplicate file finder and a DOS command utility.

Drag And File works at several levels of sophistication and integrates with other management and utility programs. The result is an uncommon degree of flexibility: Drag And File can be configured to meet your needs, your working style, and your experience. When you need more, Drag And File delivers.

Unlike most other Windows file managers, Drag And File allows you to highlight individual files and tag multiple files, which makes possible batch operations on non-contiguous groups of files.

Drag And File offers a broad range of file management tools:

- Drag-and-drop file move, copy, and delete
- Viewing of all text and most graphics files
- Tree and branch batch operations on all files
- Single click execution of frequent tasks, including viewing
- Separate windows for each drive
- Full configurable hot key control for hands-on keyboard execution
- Formatting and disk copying for floppy diskettes
- Full access to the Windows 95 Shell functions like creating shortcuts, Quick View and file properties.

Drag And File displays a window complete with toolbar

and menu choices for each drive selected. You may open up to 12 drive windows simultaneously.

The entire program can be run from a single small Drivebar which floats unobtrusively on your screen. The Drivebar makes complete directory and file information just a mouse click away.

SYSTEM REQUIREMENTS:
MS-Windows 95.

Shareware provided by the North Texas PC Users Group.
This README prepared by Jan Parkhill, edited by Willard Davis.

Disk 1016. Sound Shuffler 1.0, 2/95 – Twenty WAV sounds for Windows by M. Boyer, 5437 D Briardale Lane, Dublin, OH 43017. Internet: mboyers@csi.compuserve.com. Shareware Fee: \$5.00.

Sound Shuffler "randomizes" up to twenty different WAV sounds for your Windows



start up and close down. If you get tired of hearing the same sounds each time you open and close Windows, this is the program for you.

You must provide VBRUN200.DLL, provided by the DOM on a separate disk.

Sound Shuffler will automatically shuffle and randomize the WAV sounds each time you open or exit Windows. This is done through changes in your WIN.INI file, which can be deleted or changed at any time.

For automatic shuffling of WAV sounds, it's suggested you put Sound Shuffler in your Windows StartUp group window. It only runs long enough to inform WIN.INI to shuffle the sounds, so there is

no continuing hogging of memory.

SYSTEM REQUIREMENTS:
Windows 3.x and hardware to run that program.

Shareware provided by the North Texas PC Users Group.
This README prepared by Jan Parkhill, edited by Willard Davis.

Disk 1017. Help Writer's Assistant 2.0, 7/95 – Evaluation Version by Olson Software, 4 Anaru Place, Palmerston North, New Zealand. Compuserve: 100352,1315 Internet: stefan@olson.manawatu.gen.nz.

Shareware Fees: HWA V2.0 (New License) US \$199.00

HWA 2.0 Upgrade from HWA 1.1 or OSHTools 1.2 US \$ 70.00

HWA 2.0 Upgrade from HWA 1.1 and OSHTools 1.2 US \$ 55.00

Help Writer's Assistant is a shareware application that, well, assists you in writing Windows 3.1 Help Files. Providing a help file puts the finishing touch on the Windows applications you may develop, but that's not the only use for Windows Help files. They can be used for tutorials, standalone (hypertext-searchable) documentation that you'll know can be used on any Windows system, or other documentation (such as entertaining stories for your children or grandchildren).

This latest shareware version of Help Writer's Assistant is "feature-rich" for shareware and a professional (commercial) version with additional features, such as "decompiling" an existing help file as a start for your own help file.



The list of capabilities of the professional version compares favorably with the features of other commercial help-writing software. Admittedly, the registration fee is on the high side for shareware and the cost of the professional version is competitive with other high-end products. At least, you can give this one a try, without obligation, through this evaluation version - it's limited to twenty help topics, so can be used to prepare a small sample of a large help file or to complete a very limited help file for a small application.

This evaluation version also contains a worthwhile explanation of help files, what the components of help files are, suggestions on how to structure your help files, and a very good tutorial illustrating how to use HWA to prepare a "standalone" help file to take advantage of the hypertext capabilities of the help engine.

You must have a copy of pkunzip to unpack the file on this disk.

This software was donated by NTPCUG member and SIG Leader, Larry Linson.

This README prepared by Larry Linson, edited by Willard Davis.

Disk 1018. MYMD2QIF 4.8, 9/95 - Utility to convert MYM to Quicken format by Ranny A. Meier, 1050 White Road, Chesterfield, MO 63017. Internet: 7045L2340@compuserve.com. Shareware Fee: serialware.

MYMD2QIF is a conversion utility tool to convert Mind Your Money (MYM) for DOS (versions 9, 10 and 11) to MS Windows Quicken QIF format. This includes money, portfolio, Linked accounts, all transfers, Account Allocation in Splits and CFree payments.

The author uses cash and credit card transfers extensively, therefore he felt a need

Willard Davis retires as DOM Production Manager

Willard Davis is retiring from his duties as the Disk of the Month (DOM) Production Manager. Will has spent countless hours working with Merlin software, checking README files for correctness and seeing that our program disks were delivered to our monthly meetings with dispatch and promptness. While it's always difficult to replace a long-standing and competent volunteer, we wish Will the very best in the future.

Our new Production Manager is also a long standing-member of the DOM team, Gene Carleton. Gene has been with the DOM as a volunteer member of the DOM Booth in the basement sales area and has served several years as one of our Shift Supervisors. It's with great pride I get to welcome Gene in his new position of responsibility... You see, Gene was my Shift Supervisor when I first began my own volunteer efforts! Welcome aboard your new ship, Gene, and a hearty farewell to Willard Davis with our thanks and appreciation.

Jan Parkhill

DOM DISKS ...CONTINUED

to convert this data for use in his Quicken program. Portfolio and Linked account data is reorganized to translate as if the cash balance had been maintained in the Portfolio account all along. The resulting QIF files can be imported into Quicken or MS Money.

Two files, CMDIALOG.VBX and VBRUN300.DLL (not included) must be copied to your \WINDOWS\SYSTEM directory for the program to run properly. The other files can be copied or installed into a directory of your choice, perhaps named \MYMD@QIF.

The file VBRUN300.DLL is available on disk from the NTPCUG Disk of the Month collection entitled VBRUN Series.

SYSTEM REQUIREMENTS: Windows 3.x and hardware to run that program.

Shareware provided by the North Texas PC Users Group.

This README prepared by Jan Parkhill, edited by Willard Davis.

Disk 1019. WALLPAPER MANAGER 1.2, 2/95 - Randomize Window's Wallpaper by Mike Owens, Blind Mellon Software, 8836 Channing Drive, Jonesboro, GA 30236. Internet: owens1@ix.netcom.com. Compuserve: 75037,2625. Shareware fee: \$15.00.

This is another program to make changing your Windows appearance easier and simpler without effort on your part.

Wallpaper Manager does pretty much what the title implies. Basically, for those of us using wallpaper effects in Windows, this will allow Windows to change your screen look automatically on-the-

hour without changes being made manually.

You will find that you can set up this program to run with hourly wallpaper changes being made by the program or you can modify the schedule to your own specifications.

New bitmap wallpapers are included with the program and you can modify existing wallpaper .BMP files to work with the program as well.

This visual basic program requires that you have VBRUN300.DLL file installed in your \Windows\System subdirectory before running. You will find the entire VBRUNxxx.DLL series files available on disk from the NTPCUG DOM disk of the month.

SYSTEM REQUIREMENTS: Windows 3.1, Windows for Workgroups 3.1/3.11. Requires VBRUN300.DLL available on another DOM disk.

Shareware downloaded and submitted to the North Texas PC Users Group.

This README prepared by Jan Parkhill, edited by Willard Davis.



INSIDE THE NORTH TEXAS PC USERS GROUP COMMUNITY

VOLUNTEERS IN ACTION



by Claude McClure

Volunteers Make North Texas PC News Fun to Read

A box full of newsletters just arrived at my office. They will be distributed at the next monthly meeting of the NTPCUG. I checked the new issue for a moment, and was greeted by the fresh smell of printer's ink that made turning the cover page irresistible. This newsletter is a work to be proud of. It is produced every month by a dedicated group of volunteers. It is the vital communication and educational link that holds our club together in this era of remote work groups and electronic walls.

Reagan Andrews publishes this newsletter monthly with support from his staff, Editor Gerry Heine, and Assistant Editors Alan Lintel, Doug McCoy, Linda Moore, and John Gourd. Advertising is directed by Connie Andrews. They would be among the first to want to thank the many SIG leaders who regularly contribute worthy articles. The newsletter is a work of many volunteers and when the last edit is made, Reagan says, "We have a newsletter this month." - Thank you, Reagan. We really do.

Thanks to all of the many members who work behind the scenes to put it all together on our monthly meeting date. Thanks to the many volunteers who are named on this page.

Infomart Liaison

- Stuart Yarus
- Alex Lilley
- Robert Hilliard

**Vendor Setup/
Breakdown**

- Anchors:**
 - David Slavik
 - Kenneth Berg
 - Ross Jones
- Crew:**
 - Dick Abbot
 - Larry Johnson
 - Neal Van Pelt
 - David Temple
 - Wayne Washburn
 - Larry Matzek

Auditorium Presentations

- Timothy Carmichael
- Chris Jung
- Chris Carrichael

**Information/
Registration Booth**

- Statistician:**
 - Connie Andrews
 - Ralph Beaver (Assistant)
- Scheduler:**
 - Bob Wuller
- Anchors:**
 - Al Aston
 - Ralph Beaver
 - Lorin Cranford
 - Eteta E. Eta
 - Allan Harbaugh
 - Hank Holt
 - John Ivers
 - Carl Oehmann
 - Ramond Reyes
 - Bob Wuller

- Booth Crew:**
 - Deborah Bean
 - Chris Brooks
 - Albert Champon
 - Tim Foster
 - James Gorak
 - Claude McClure
 - Martin Moomaw
 - Ray Szczesniak
 - Fred Toulmin
 - Frank Winans

- Walkabout:**
 - Linda Moore
 - Perry Slack

Disk of the Month (DOM)

- DOM Shift Supervisors:**
 - Joe Allen
 - Roy Bales

- James Donlon
- M. Pat Henley
- Oscar Tyler
- DOM Desk Crew:**
 - Michael Ashley
 - Douglas Athas
 - Bernie Baars
 - Richard Blair
 - Gene Carleton
 - Mark Christopher
 - William Farris
 - Charles Fernandez
 - Mac McKeethen
 - Jan Parkhill
 - Bob Post
 - George Read

With Special Thanks to:

- Set Up Crew:**
 - Mark Gruner
 - M. Pat Henley
 - David Huckabee
 - Jan Parkhill
- Inventory and Take-down Crew:**
 - Richard Blair
 - Mark Christopher
 - Jan Parkhill
- DOM Desk Scheduler:**
 - Philip Bridge
- Disk Production:**
 - Howard Hamilton
 - Willard Davis



VOLUNTEER INFORMATION

- 1. Via BBS:** (214)387-2751, (214)387-2752 or (214)263-9036 (metro). Sign up on the Volunteer Conference - make the subject matter your area of interest.
- 2. Meeting day:** Sign up at the Information Booth or DOM Booth to work those areas in a coming month.
- 3. By phone:**
 - Auditorium Presentations**
 - Timothy Carmichael (214) 661-4626 (w)
 - DOM Booth Scheduler**
 - Charles Cashion (214) 881-0952 (h)
 - (214) 519-2583 (w)
 - DOM Software Review**
 - Jan Parkhill (214) 828-2216 (h)(w)
 - Information Booth and General Information**
 - Claude McClure (214) 867-0978 (h)

Selected SIG Reports . . .

News and meeting notes of Special Interest Groups
(Material for this column should be sent to NTPCUG BBS SIG Upload Area before the 10th day of each month)

Access SIG

Plans for our December meeting aren't firm at the time of this writing. Rest assured, however, that we will have a meeting and information that we think will be useful — there's still more to discuss about Larry's Address Book Example application for Access 2.0.

Our goal is to cover subjects of interest to every level of Access user, from the person still deciding on a database to the experienced developer. We need speakers for future meetings on both Access 2.0, Access 7.0 for Windows 95, controls, add-ins,

add-ons, and other Access-related subjects — perhaps your own Access application or just how you use Access as an end-user.

Between meetings, keep up with the group, and Access, on the NTPCUG electronic bulletin board system. The Internet "comp.databases.ms-access" newsgroup is back in operation and chock-full of good questions and answers. We also have our own local MS ACCESS message conference for questions, answers, announcements, and just keeping in touch. Check inside the back

FROM THE SIG COORDINATOR

The following are changes/additions/needs that the NTPCUG has made to the SIG's.

SIG Name Changes:

- Introduction to the PC — formerly Personal Users SIG

New SIGs:

- Delphi — Fred Williams @ (214) 492-1315

New SIG Leaders:

- StarText — Bill Jones @ (214) 423-8486 h
- StarText — Chuck Menke @ (817) 496-6579

Groups Looking for Help in Leading their SIGs:

- Middle C [Contact Tom Cook @ (214) 871-8177 w]
- Networking [Contact Bernie Van Roekel @ (817) 451-4540 h; (817) 461-4120 w]
- Desktop Publishing [Contact Deborah Bean @ (214) 475-7463 h 475-3124 w]
- Visual Basic [Contact Jim Carter @ (214) 235-5968 h]

The requirements for forming a SIG are:

Leadership — at least one individual willing to lead the SIG, and an assistant.

Membership — at least eight individuals willing to attend the SIG fairly consistently.

If you have a group that meets these qualifications or would like help in finding others who might share your interests, please contact me at (214) 517-7430 (H) or (214) 527-0922 (W).

SPECIAL INTEREST GROUPS SIG LEADER LISTINGS

SIG Coordinator

Alex Lilley (214) 517-7430 h

Legend: h = Home #, w = Work #
M = Metro #

ACT !

Jim Thompson (817) 261-6159 h
 (214) 953-0051 w
 Deborah Bean..... (214) 475-7463 h
 (214) 475-3124 w

Access

Larry Linson (817) 481-2350 hM
 Jack Atkinson..... (817) 481-6623 h
 Dianna DeCicco.. (214) 446-0639 h
 Frank McCoy..... (817) 232-2483 h

Alpha 4

Ron Jackson (214) 276-3661 h
 Ken Brooks (214) 238-5959 w
 Bill Parker..... (214) 369-5889 h

Applications Developers (OLE & ODBC)

Larry Linson (817) 481-2350 h
 Linda Moore..... (214) 342-8833
 Vince Prehn (214) 880-0000
 Dan Ogden..... (214) 556-0668 w

Assembly Language SIG

Glynn Brooks (214) 578-8737 h

BASIC - Beginning

Chuck Jacobus ... (817) 379-6840 h
 (817) 379-5287 w

BASIC - Classic

Brother's Keeper

Neil Sunderland .. (214) 272-2869 h

Business Applications/DAC

Putt Shaw..... (214) 235-2559 h
 Bruce Schubert ... (214) 394-5328 h
 (214) 233-8353 w

C++/Advanced

Kent Cobb (214) 343-3862 h
 Tom Cook (214) 871-8177 w

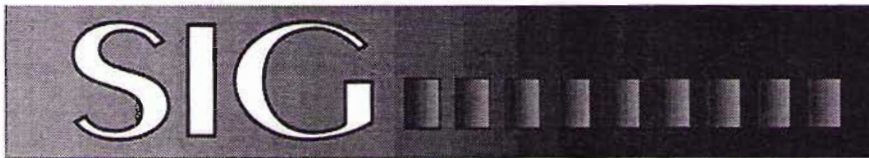

cover of this issue for the BBS telephone numbers.

We look forward to seeing you at the December meeting. Come join us!

Larry Linson

Application Developers SIG (OLE AND ODBC) SIG

We could call our December meeting a *mystery meeting* and tell you that you'll have to come and find out what it's about — in fact, our plans are still in a "nebulous" state as this is written, but we're working to have an interesting presentation of useful information.

OLE 2 is, reportedly, much enhanced in the Windows 95 environment (and, also, in Windows NT 3.5.1 and later). We realize it has not been the easiest of subjects to deal with in Windows 3.1, but we hope that the discussions here have helped



you over some of the rough spots.

We're looking for more presenters on the subject of early experience with Windows 95 and the "new generation" of applications, with emphasis on our chosen topics, OLE and ODBC (both improved in the new environment). If you've begun to work in these areas, won't you share your insights with us?

Come join us for the December meeting!

Larry Linson

Assembly Language SIG

In November we concluded a discussion of Internet services and how programs connect to them. We also discussed the features built in to Windows 95 that make connecting a PC to the Internet easier than ever.

In December we'll be having an open forum. The only scheduled item is to come up with discussion topics for the next few months, so that will leave plenty of time to discuss questions and experiences from the floor.

Glynn Brooks

Business Applications/ DAC SIG

Our November 18th SIG meeting featured **Keith Powell**, software specialist with Charles Schwab & Co., giving us a look at the newly updated, Windows version of *SmartSuite*. This smooth-running software will provide a great method of keeping up with your investments, whether they are in

SIG LEADER LISTING

Legend: h = Home #, w = Work #
M = Metro #

C++/Beginning

Tom Cook (214) 871-8177 w

CAD

Bill Sephton (214) 296-1799 h
..... (214) 387-3500 w
Neil Culver (214) 690-6552 h
..... (214) 235-3031 w

Communications

Doug Gorrie (214) 618-8002 h
..... (214) 464-7942 w
Birl Smith..... (214) 960-8227 h
..... (214) 220-9388 w

Dallas, Corel

JoAnn Elliott (214) 231-5332 h
Marsha Drebels (214) 951-0266

DOS

Jim Hoisington (214) 416-3101 h
Reagan Andrews (214) 828-0699 h

Datalflex

David King (817) 640-6130 hM
..... (214) 313-0408 w

Delphi

Fred Williams (214) 492-1315

Desktop Publishing

Deborah Bean..... (214) 475-7463 h
..... (214) 475-3124 w
Ray Hackney..... (214) 437-2439 h

Fox Pro

Kevin White (214) 644-5008 w

Genealogy - General

Al Sanford (214) 278-7888 h

Genealogy - PAF

Joe Waldrop (817) 498-5856 h

Genealogy - Roots III / IV

John Wylie..... (214) 495-4410 h

Genealogy - The Master Genealogist

Jeri Steele (214) 306-1596 h
..... (214) 917-3917 w

Graphics

Neal Berkowitz (214) 475-7463 h
..... (214) 475-3124 w

Hardware Solutions

Charles Miller (903) 938-4220 h
Ralph Beaver (817) 624-9530 h
Gary Johnson..... (214) 938-0344 h

SIG LEADER LISTING

Legend: h = Home #, w = Work #
M = Metro #

Health Care Computing/Informatics
Zeke Rabkin (214) 321-9462 w

Internet-Beginner

Tom O'Keefe (214) 247-8812 h
Doug Gorrie (214) 618-8002 h
..... (214) 464-7942 w
Erik Leaseburg ... (817) 265-7550 hM

Internet-Advanced

Tom O'Keefe (214) 247-8812 h
Doug Gorrie (214) 618-8002 h
..... (214) 464-7942 w
Erik Leaseburg ... (817) 265-7550 hM

Introduction to the PC

(formerly Personal Users)

Alex Lilley (214) 517-7430 h
..... (214) 527-0922 w
Bob Russell (214) 422-4269 h

Investors

Dick Richtman (214) 437-0322 h

MS Word for Windows

Beverly Kurtin (817) 355-9594 hM
Jan Patton (903) 886-6249 h
..... (903) 886-6466 w
Bob Rice (214) 885-0202 w

MS Works

Ralph Logan (817) 498-9746 hM

Microsoft Networking

Debbie Lenhart ... (214) 625-9680 h
..... (214) 716-2704 w
Bruce Wynn (214) 335-2507 h
..... (214) 756-7832 w
John McCrae

MultiMedia

Dennis Rice (214) 680-8299 h

Networking

Bernie Van Roekel
..... (817) 451-4540 h
..... (817) 461-4120 w
Leroy Tennison
Francis Bright

OS/2 Developer

James Dunn (214) 279-5712 h
..... (214) 497-8978 w

OS/2 for End Users

Bob Fermier (817) 481-6625 h
..... (214) 444-2195 w

OS/2 Q&A

Larry Truesdale

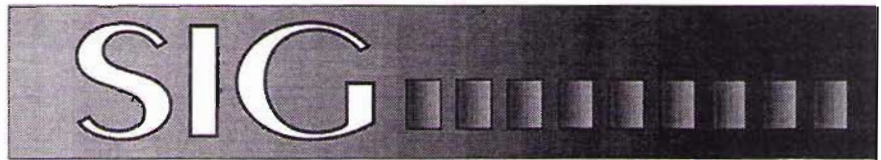

your Schwab account, an account with any other brokerage firm, or a hypothetical portfolio to test your ability as a trader. Of course, you must have an account of some kind with Schwab to activate the link, but even an IRA account will do.

The user is provided access to many of the financial services which dwell in cyberspace through Schwab's CompuServe link of those services are fee-based but on-line time is provided on a no-fee basis. The user is given up to 100 real-time stock quotes plus an additional 100 for each stock transaction through Schwab, with fees discounted 10% for trades on-line.

In December, Bruce Schubert will give a demonstration of QuickBooks, designed for the person who may be shopping for a computerized accounting program. Those who like the program will have an opportunity to meet with other QuickBooks users at their 2:00 pm SIG meeting, to improve their understanding of the use of the software. The existence of a software specific SIG is always a big help to new users so it's nice to know that the QuickBooks SIG is there to provide assistance!

Hope that you can be with us at 1:00 pm on December 16.

Putt Shaw

C/C++ SIG- Advanced

At the November meeting of the Advanced C/C++ SIG, we discussed some of the "dos"

and "don'ts" in Scott Meyer's book, *Effective C++*. As many of you know, this is one of my favorite C++ books. It's particularly good after you've gotten past the beginner stage, and you're wondering, "What do I do now?" The debate was lively, the questions were insightful, and a good time was had by all.

In December, Mark Nelson will join us to discuss STL, the Standard Template Library. Mark Nelson is a programmer for Greenleaf Software, a C/C++ library vendor in Dallas. He is the author of *The Data Compression Book*, *Serial Communications: A C++ Programmer's Guide*, as well as his most



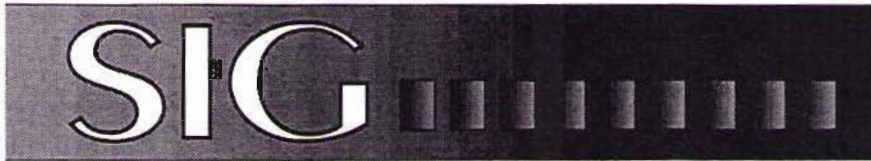

recent effort, *The C++ Programmer's Guide to the Standard Template Library*.

For those of you who haven't kept up with X3J16, STL is a template-based set of containers and algorithms that were added to the ANSI C++ specification last year. The STL promises to make major changes in the way C++ programmers code during the years to come. Mark will be talking about what the STL is going to mean to us as it is adopted by compiler vendors. Please join us!

Kent Cobb and Tom Cook

Dallas Corel SIG

December Meeting

White Elephant Software Exchange and *CorelDRAW* Conference Review

Dallas Corel SIG of the North Texas PC Users Group (formerly the DACAD SIG) will hold a white elephant software exchange party at the December 16 meeting. The rules are as follows:

1. You must bring software to participate (to receive other software). You may bring as many programs as you like.



- 2. No shareware or freeware.
- 3. What you bring must be Windows-compatible software, less than 2 years old, and something you think others would be likely to enjoy trying.
- 4. Please package in boxes, plastic or zip bags.

Also, Susan Biggs and JoAnn Elliott will demonstrate some of the new things they have learned at the CorelDraw International User's Conference.

October Meeting in Review, Corel Lens Features

Linda Hume will present an overview of CorelDRAW Lens features. She will demonstrate the different lenses available in Draw 5.0 with art examples of use for Transparency, Brighten, Magnification, Invert, Color Add, Color Limit, Tinted Grayscale, and Heat Map lens examples. Linda also gave out a very useful table of lenses and their capabilities. Many thanks to her for her continuing contributions to this group!



F1 - Give Help

Printing Texture Fills/lenses

Creating your own flow chart in Draw? Decide to move the shapes? Does it take many steps? Try this - select all the shapes and connecting lines, then combine them. Now, use the node edit tool to select the nodes that correspond to the shapes you want to move, including the end nodes of the re-

SIG LEADER LISTING CONTINUED ...

Legend: h = Home #, w = Work #
M = Metro #

Paradox

Fred Williams.....(214) 492-1315 h
Tom Browning.....(214) 692-9784 h

Programmers

Kent Kingery.....(214) 317-0125 h
Jim Hoisington.....(214) 416-3101 h

QuickBooks

Jim Thompson.....(817) 261-6159 h
.....(214) 953-0051 w

Quicken

W. L. Harris.....(214) 291-7616 h
.....(214) 462-3676 w
Phil Faulkner.....(214) 239-0561 h
.....(214) 819-4446 w

Spreadsheet/Spre.Dev

Mark Gruner.....(214) 964-8174 h
.....(214) 605-8447 w
Adam Peterson.....(214) 682-0725 h
.....(214) 864-2760 w

StarText SIG

Bill Jones.....(214) 423-8486 h
Chuck Mencke.....(817) 496-6579 h

UNIX

Jim Stallworth.....(214) 789-3783 h
.....(214) 604-2226 w
Doug Scott.....(817) 261-4653 hM
.....(817) 878-0367 wM

Visual Basic — Beginning

Jim Carter.....(214) 235-5968 h

Visual Basic

Jim Carter.....(214) 235-5968 h

Windows - Applications

Neal Berkowitz(214) 475-7463 h
.....(214) 475-3124 w
Deborah Bean.....(214) 475-7463 h
.....(214) 475-3124 w

Windows - Developers

Art English.....(214) 618-1266 h
.....(214) 232-3310 w

WordPerfect / DOS

Dawn Hopkins.....(214) 613-8815 h
.....(214) 740-8085 w

WordPerfect / Windows

Cindy Adams.....(817) 481-1300 wM

lated connecting lines, move to new location, and ta da! The connecting lines just stretch to the new location automatically!

From *ACAD October Newsletter*

Now I Need Some Help!

Please, if you have the time, can make deadlines, and would like to help the group, consider writing this article monthly! I've been using a standard format for the SIG report, and you can follow it if you like! All you need is a modem to submit the article to **Reagan** on the NTPCUG BBS.

JoAnn Elliott

Delphi SIG

This month, December, I'm still planing on demonstrating the ease of installing and using third-party development components. Since we have two evaluation copies of one of the components I'll be demonstrating, it looks like give away time!

The third-party component segment of the Delphi market is literally exploding with products which allow the simple addition of very simple, "Wow why didn't I think of that?", type components to very elaborate and robust components that practically implement an entire subsystem with the drag and drop of a single icon on a Delphi form.

We will not be demonstrating one such component at the December meeting but, someone is offering a Delphi component which provides a full featured Web Browser (aka, Netscape like). So you may provide your user with full WWW access, by dropping a single component icon on your Delphi form!

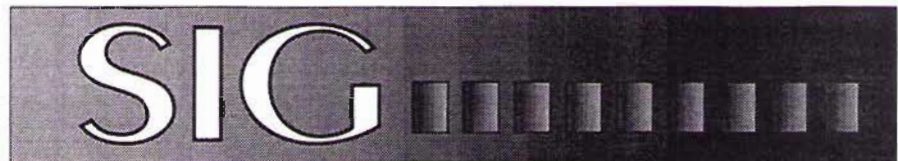

This is to be the last meeting in the SIG Leaders' "long term" meeting plan. I do know that one attendee has offered to do a "How I incorporate Crystal Reports into my Delphi Applications." More on that one soon I hope, as I am not even close to being a fan of ReportSmith.

Come join us. Some day "real soon now" we expect to have a presentation on the new 32bit Delphi. That one will most likely occur on very short notice. So, if you're not there you just may miss it!

Fred Williams

DOS SIG

It lives! It lives! DOS ain't dead!

Heard the good news from Symantec's CEO, **Gordon Eubanks**, at Comdex just before the *PC News* was put to bed for the month. What that means for us and for vendors is unclear, but Eubanks does think DOS will be alive and kicking for several more years.

Might be time to look at the DOS under *Windows 95* and discuss how some of the utilities (they're still there) have been changed/alterd/enhanced/





ar SIG members' reports on their experiences running DOS 7.0 alone and how applications behave in this mode. Also may be interesting to hear reports about the various "ram-doublers" since there's been a lot of controversy about these in the media.

Hard-core hardware addicts may want to forego the DOS SIG in favor of the Adaptec presentation at 9:00 in the auditorium. Don't know what they'll be showing, but a lucky guess might be EZ SCSI 4.0, Adaptec's SCSI installation, configuration and troubleshooting utility.

Down the road, in January, we may hit DOS from a hardware viewpoint (again) and look at why PC selection may hinge on users' typical use patterns more than it has in the past. Or, why software and operating system (OS) choice may hinge on existing hardware. This all a result of questioning CPU vendors at Comdex and hearing their descriptions of the various roads to CPU optimization traveled recently by AMD/NexGen, Cyrix, Intel and TI.

Reagan Andrews

INTERNET SIG - BEGINNING

At the November meeting, new SIG Leader Erik Leaseburg continued his discussion on "How to Create a Home Page on the World Wide Web." This was Part 2 in a series. Erik's presentations are always well received, and Erik seems to enjoy doing them - a dangerous combination in an all-volunteer organization!

At our December 16th meeting, one of our past presenters, Lana Bryan of TeacherSoft, has arranged a presentation on *InterGO*. InterGO is the first product to seamlessly integrate browsing, searching, E-mail, file transfer, virus scanning, and screening for objectionable material. Also included with InterGO is a wealth of reference material - an encyclopedia, dictionary, thesaurus, atlas, Internet guide, and hyperlinked literary library.

InterGO is the first Internet product to meet the needs of students, parents, and educators. One component that makes it unique is KinderGuard, TeacherSoft's exclusive screening technology, which blocks unwanted pictures, World Wide Web and gopher documents, file transfer sources, news and discussion groups, and even mailing lists.



InterGO also supports SafeSurf, an emerging rating standard that lets parents control the amount of various classes of objectionable material accessible to young users.

InterGO was developed specifically with learning in mind, both at home and at school. Each copy of InterGO can support many users, whether a classroom of students or mom, dad, and the kids. Each user can be assigned a different access level so that any material viewed is age-appropriate. Users can each have a personal E-mail account and can customize InterGO to suit their own interests.

InterGO has some special features not easily available in other packages. Want to find a term you don't know, anywhere on the Internet? Select it and click, and InterGO lets you look it up automatically in the Columbia Encyclopedia, American Heritage Dictionary, or anywhere in the Internet. You can also copy text and graphics from the Internet and paste them into your word processor.

Is spelling a problem? InterGO automatically corrects spelling errors in E-mail messages and search requests, an especially useful feature if you're searching for something like "hieroglyphics."

How about virus concerns? InterGO automatically scans for viruses in files you download from the Internet.

InterGO is in part addressing a different facet of the Internet community - KIDS. But a lot of the features can help us adults, too. Lana can answer all your questions about this brand new product, including how it can help teachers and parents guide their kids in using the Internet effectively.

into the end of the Christmas shopping season, and maybe some product giveaways to boot. Come join us!

*Doug Gorrie, Tom O'Keefe &
Eric Leaseburg*

INTRODUCTION TO THE PC SIG

The following is the tentative schedule for SIG classes that will be offered as an Introduction to the PC during the next four months. These classes, beginning with Class 1, were originally scheduled to begin at the November 18 meeting but had to be postponed until December due to a shortage of volunteer instructors in November. Classes can be taken in any order suitable to the individual student's schedule. Printed notes are provided during classes.

December 16, 1995

- ❖ 9:00 Class 1
Introduction to the SIG and the Personal Computer
- ❖ 10:00 Class 2
Working with Files & Directory Structures
- ❖ Noon Class 3
Disk Operating System (DOS) - Part I
- ❖ 1:00 Class 4
DOS - Part II

January 13, 1996

- ❖ 9:00 Class 5
Graphics for the PC
- ❖ 10:00 Class 6
Word Processors
- ❖ Noon Class 7
Spreadsheet Programs
- ❖ 1:00 Class 8
Other Software for the PC

February 10, 1996

- ❖ 9:00 Class 9
Hardware for the PC

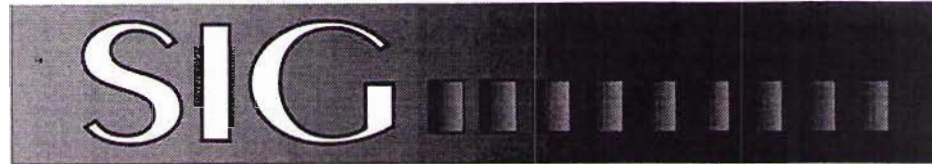

- ❖ 10:00 Class 10
Printers for the PC
- ❖ Noon Class 11
Overview of Quicken Accounting Software
- ❖ 1:00 Class 12
Modems & Telecommunications
- ❖ 2:00 Class 12a
NTPCUG Bulletin Board System (BBS)

March 9, 1996*

- ❖ 9:00 Class 13
Overview of Microsoft Windows
- ❖ 10:00 Class 14
Overview of multimedia Software & Hardware
- ❖ Noon Class 15
Disk of the Month (DOM)
- ❖ 1:00 Class 16
PC's Into the 21st Century

* These dates are subject to change. Check your *PC NEWS* and/or the NTPCUG BBS for corrected dates before the meetings.

Alex Lilley

MS Word for Windows SIG

After several months of lazing around I'm back where I belong, leading the SIG, while our able assistant SIG leader, **Jan Patton** gets a chance to relax again.

It's been one heck of a recovery, but for the most part I'm able to speak without tripping over my tongue too badly. They say that any health problems will get you were you live, and I "live" by giving computer support. All I can say is it's great just getting out and about.

Now don't think I've been sitting on my posterior. I've been cramming my head full of Windows

95 data and translating what that means for the future of Word processing, particularly as it relates to Word for Windows. While I don't presume to have it all down pat (NOBODY does), I'm confident of one thing, it's an exciting future.

One thing I've noticed in the media is that almost nobody has paid attention to the fact that documentricity has arrived. Put another way, applications don't matter the way they used to matter. The days of worrying about which document goes with which application is just about at an end. Let that sink in for a few minutes, shake your head the way I did, and say "huh?"

For example, let's say that you've just created and saved a document in Word 95, you scoot over to *Excel* to create a spreadsheet and save it and then develop a cool multimedia *PowerPoint* presentation. By using something called the "Binder," you can just clip 'em together



SIG

and . . . well, you'll just have to see it to believe it.

As you go through the Explorer and find a document, just click on it or double-click or . . . oh heck, come to the December meeting and see it for yourself.

And now the Tip of the Month.

Autotext.

Have you ever wanted to store stock phrases (boilerplate) text or even an entire document in a manner that would make it available to you just by typing a letter or two and pressing another button?

WordPerfect users will recognize that as a perfect place for what they call a keyboard macro. Well, Word makes it easier.

WELCOME BACK!

A heartfelt welcome back to **Beverly Kurtin**, Microsoft Word for Windows SIG leader. Beverly suffered through some medical setbacks recently which caused her to take a leave of absence from serving as SIG leader. She is coming back like gangbusters.

One of her strengths is in her sense of humor and the way she connects with people. She is a delight to know and her SIG notes are fun to read and informative.

Beverly is very grateful for all of the support she received from our members, and especially the very able assistance she received from **Jan Patton** and **Bob Rice** in leading the SIG in her absence.

Let's take a phrase such as "Your account is now 30 days past-due or 60 or whatever." Simply select the text that you wish to be able to recall, select Autotext from the Edit menu (or use Alt, E, X), type 30 in the Name area, press Enter and get on with life.

The next time you need to tell someone "Your account is now 30 days past due" you'll just type 30 and touch F3. I swear to you, that's all there is to it.

In Word 2 you use the Glossary entry. Not bad, huh?

Jan and I hope to see y'all on December 16 and take this opportunity to wish you all a safe, happy and most important of all, a loving holiday season.

Beverly Kurtin

PARADOX SIG

Rumor has it that Borland has been trying to sell Paradox to Novell. Now Novell has made public noises that the whole Novell "Applications" group (Perfect Office) is up for sale. In the very competitive Office Suite market, Perfect Office has been steadily losing ground to Microsoft's Office suite. Novell has wisely chosen to refocus on the market segment that made them, network OS. Although it may be too little, too late.

As I write this, some on the Internet have noted that they have received special offers from Borland for the forthcoming 32bit, Paradox 7.0, Win '95 release. No ship date has been published.

Jeff Hopper, one of the local Borland reps, has indicated that 32bit and 16bit Paradox cannot reside on the same machine. This is one of the good reasons to attend the Paradox SIG. Every once and a while, deadly little bombs like this are dropped during a presentation. If you don't attend the SIG, I just may not remember to include in the SIG notes, then you're going to find yourself up that well known creek without a lawnmower, or something like that.

If you made the November SIG you will have learned how I trim up the Paradox environment so as to protect my programs and the poor user from himself. There are some very basic steps you can take each time you start up an application that will "clean up" the display and turn off access to many unnecessarily, and downright dangerous, Paradox interactive functions.

I'd bet **Tom Browning** will be back up in December, with his typical good presentation. So come join us as we continue to



find more and more things we didn't know about Paradox.

Fred Williams

PRO SIG

Tempers flared during a discussion of scripting languages. There were many proponents of the venerable BAT language. A few programmers said that Object REXX was better. The UNIX heads said that neither of those languages could begin to compare to the C shell and the Korn shell scripting languages.

But the argument was won by an old gray-haired programmer in the back of the room who pointed out that MVS JCL was the best scripting language because if you could master its complexity, you were guaranteed employment for life.

Join us in December when we attempt to build a relational database using only 1's and 0's.

Jim Hoisington

Visual Basic SIG - BEGINNING

This month's presentation on December 16 will include a discussion of reusable code in Visual Basic. I will describe several levels of reusable code in Visual Basic - an example that members can use in their applications. If you have an example of reusable code that you use, bring it along and we can discuss it also.

For background reading on this subject, I recommend two articles in the October issue of *VB Tech Journal*. The first is "Reusable Components in (Gasp!) Basic" by Tony Kyle and the second is "Writing Highly Reusable Code" by Edward Troxel.

Last month, we talked about the impact of Visual Basic 4.0 on beginning Visual Basic pro-

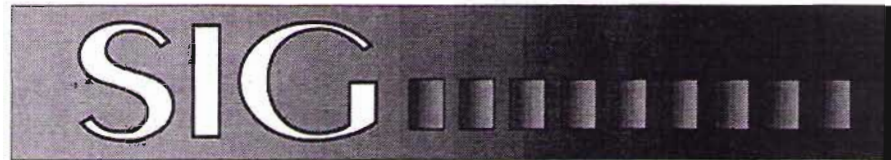

grammers. Copies of Visual Basic 4.0 are just now showing up on our doorsteps. Plans for the upgrade of the NTPCUG teaching computer to Windows 95 are now being formulated and I hope will permit installation of Visual Basic 4.0 by year's end.

Bring your questions on Beginning Visual Basic to our meeting beginning at 8:00 AM on Saturday, December 16, 1995. Check the Infomart lobby screens for the correct room assignment.

Jim Carter

Visual Basic SIG

The December 16th meeting of the Visual Basic SIG will be an open forum. Bring your Visual Basic questions and we will all try to obtain answers. As most of you know, **Woody Pewitt** has relocated to California and

we do not have a new SIG Leader yet. Anyone wishing to lead the Visual Basic SIG, please contact me for details.

As Assistant SIG Leader, I will moderate the Visual Basic SIG meetings and hope that members will step forward to make presentation at these meetings. If you feel you can make a contribution, give me a call and I will coordinate these presentations.

Bring your questions on Visual Basic to the Visual Basic SIG meeting at 9:00 AM on Saturday, December 16, 1995. Check the room assignment in the Infomart lobby.

Jim Carter



Today, I-Mail — Tomorrow, maybe I-net Newsgroups?

BBS Internet Update

Our own Doug Gorrie and On Ramp's Eric Schnoebelen continue to hammer and bang on the Internet feed. As a final step in securing the E-mail feed, Doug has been bullet-proofing the connectivity between the "mail muncher" and the TBBS machine. Once that task is completed, our end of the mail feed will be at least as secure as the rest of the "Net".

Doug has progressively been restoring the news group feed also. As of the time of this writing, the full feed is back up and humming along. We have had an "eventless" feed for about two weeks now.

This is a much improved situation over the condition of things when I finally shut the news groups down a couple of



NTPCUG — ON-LINE

by Fred Williams
SYSOP, NTPCUG BBS

months ago. I could not count on the feed for more than four or five days without a trip to Addison to unscramble the muncher.

Obviously Eric has done an excellent job of adding "robustness" to the entire UUCP Feed service from On Ramp, this time around.

Many, Many Thanks

Once again I wish to thank both Doug and Eric for devoting so much effort to setting things right with the feed. Especially for Doug devoting so much of his personal time to do the grunt work required to resolve the issues involved. The next time you see Doug at a meeting be sure and thank him for this extra effort, which was wholly responsible for our continuation of Internet services on the NTPCUG BBS.

R & D

Research continues on the "next step" for the BBS. I am studying the Windows NT thing very intensely. The connectivity that we can establish to the Internet is a very, very appealing aspect of the NT thing. We should, as a minimum, gain the ability to support our own WWW "Home Page", establish a full POP3 E-mail connection, and allow members and visitors

to log on to the NTPCUG BBS machine from the Internet. So the next time one of our members heads out to some far flung place on the planet, they will be able to keep in touch without the long distance bill eating them up.

I only hope Doug doesn't burn himself out on the current setup before we can get to the "good stuff". I expect that a move to NT will require the effort of more than just myself. I wonder if Lewis Graber knows what he has let himself in for? I'd guess that I'll be looking for even more "warm bodies" as the project continues. Like in the Navy, if I ever ask for a show of hands of those with college experience, it might not be wise to raise your hand!

Fred Williams



NTPCUG USER - To - USER PROGRAM

Introducing the NTPCUG User-to-User program, composed of members who are willing to donate their time to help others with software and hardware questions. Some of our helpers are professional consultants. All have joined the User-to-User Program because they want to share their knowledge with others and help them. They agreed to answer questions that they are comfortable handling over the phone, without charge, and within

reasonable time limits (at the volunteer's discretion).

These individuals are volunteering to assist NTPCUG members. NTPCUG is assisting in finding these volunteers for you, but cannot be responsible for unsatisfactory outcomes. Next to each subject, we will list the person's name, phone number and the times they are available. Please honor the wishes of our helpers by seeking help only during those hours.

SUBJECT	HELPER	PHONE	DAYS/HOURS	SUBJECT	HELPER	PHONE	DAYS/HOURS
Access				DR DOS			
	Larry Linson	(817)481-2350	M-Sa 1300-1500		Ralph Beaver.....	(817)336-0570	M-F 0800-1700
						(817)624-9530	SS 0900-2100
Assembly Language				Hardware Help			
	Frank Cavallio	(214)423-9221	7 1800-2200		Charles Miller.....	(903)938-4220(*)	7 1900-2400
	Glynn Brooks.....	(214)578-8737	M-F 1700-2200	Internet - General			
BASIC					Erik Leaseburg	(817)265-7550(m)	7 2000-2200
	Mike Firth	(214)827-7734	7 0800-2200		David Martin	(214)717-0523	M-F 1900-2200
Beginner Problems				Internet - Telnet, FTP, NetScape, Web Explorer (OS/2)			
	Jan Parkhill.....	(214)828-2216	M-Sa 0900-1700		Bob Wilson	(214)517-1434	M-F 1900-2200
	Shirley Hudgens.....	(214)352-2800	7 0900-2000				S-S 1000-2200
Brother's Keeper				LANs — Novell			
	Neil Sunderland.....	(214)272-2869	7 0900-2200		Joseph Beasley	(214)225-8752	7 0800-2400
C++ (the language)				— Lantastic			
	Bob Adams.....	(214)328-1455	M-Sa 0900-1900		Joseph Beasley	(214)410-3818	7 0900-2200
	Howard Harkness.....	(817)267-6227	7 1000-2100	Managing Your Money			
	Doug Cochran	(214)578-9258	T&T 1800-2030		Glynn Brooks	(214)578-8737	M-F 1700-2200
CorelDraw				Modems			
	Linda Hume	(817)472-7555	M-F 1900-2200		Erik Leaseburg	(817)265-7550(m)	7 2000-2200
			S-S 1300-2200	MathCAD			
Batch Files					Bob Adams	(214)328-1455	M-Sa 0900-1900
	Charles Miller	(903)938-4220(*)	7 1900-2400	OS/2			
Borland C++					Larry Truesdale	(214)442-7074	7 1000-2200
	Bob Adams.....	(214)328-1455	M-Sa 0900-1900	PC Tools/Win			
	Howard Harkness.....	(817)267-6227	7 1000-2100		Glynn Brooks	(214)578-8737	M-F 1700-2200
Comm Software				Paradox			
	Doug Gorrie.....	(214) 464-7942	M-F 0800-1700		Fred Williams.....	(214)492-1315	7 1300-2100
		(214) 618-8002	S-S 1000-1900	PKzip/PKUNzip			
CompuServe					Erik Leaseburg	(817)265-7550(m)	7 2000-2200
	Bob Adams.....	(214)328-1455	M-Sa 0900-1900	ProComm/ProComm+			
dBASE III, III+, IV & Windows					Doug Gorrie	(214) 464-7942	M-F 0800-1700
	Ted Gilliam.....	(214)964-7923	7 0800-1700			(214) 618-8002	S-S 1000-1900
Delphi (Borland)					Bill Green.....	(817) 731-1308	
	Howard Harkness.....	(817)267-6227	7 1000-2100				
DOS							
	Bob Russell	(214)422-4269	7 1900-2200				
	Erik Leaseburg	(817)265-7550(m)	7 2000-2200				

SUBJECT	HELPER	PHONE	DAYS/HOURS
	Joseph Beasley	(214)225-8752	7 0800-2400
	Joseph Beasley	(214)410-3818	7 0900-2200
Publisher (Microsoft)			
	Bob Russell	(214)422-4269	7 1900-2200
	Pat Cote	(214)522-1717	x266 M-F 0800-1700
	(214)424-1738	7 1000-2200
Quicken			
	Billy Pitts	(817)430-8148	7 1830-2100
	Jim Hall	(214)348-7848	7 1000-2100
Quickbooks			
	Jim Thompson	(214)953-0051	M-F 0800-1800
SPFPC			
	Doug Gorrie	(214) 464-7942	M-F 0800-1700
	(214) 618-8002	S-S 1000-1900
TurboVision			
	Don Cochran	(214)578-8258	T&T 1800-2030
UNIX			
	Doug Scott	(817)261-4653	7 1830-2200
Virus & Anti-Virus			
	Charles Miller	(903)938-4220(*)	7 1900-2400

NTPCUG USER - To - USER PROGRAM

Visual Basic -

Jim Carter	(214)235-5968	7	1700-2130
L.J. Johnson	(214)495-9067	7	1700-2130
Gene Hamelman	(214)495-6342	7	1700-2130

Windows for Workgroups

Joseph Beasley	(214)225-8752	7	0800-2400
Joseph Beasley	(214)410-3818	7	0900-2200
Bob Russell	(214)422-4269	7	1900-2200

Word for Windows

Bob Russell	(214)422-4269	7	1900-2200
-------------------	---------------	---	-----------

WordPerfect 6.x WIn

Georgene Harkness	(817)267-6227	7	1000-2100
-------------------------	---------------	---	-----------

Works, Microsoft

Mike Firth	(214)827-7734	7	0800-2200
------------------	---------------	---	-----------

XENIX

Doug Scott	(817)261-4653	7	1830-2200
------------------	---------------	---	-----------

The subject areas below do not have a volunteer to answer questions. If you would like to assist or add possible categories for the future, please contact Doug Gorrie at (214)464-7924 M-F 0800-1700 or Sa & Su 1000-1900 at (214)618-8002. Doug will send you a form on which you can list your qualifications and sign.

LEGEND:

7..... All 7 days of each week M-F ... Monday through Friday
 T&T... Tuesday and Thursday M-Sa .. Monday through Saturday
 S&S... Saturday and Sunday (*)..... Caller should incur any Long Distance charges

Areas Needing Helpers:

- Borland Turbo C
- CAD
- Dataflex
- Desktop Publishing
- Easy Text
- First Choice
- First Publisher
- Fox Pro
- Harvard Graphics
- LapLink
- Money Counts
- Microsoft C
- Microsoft C++
- Microsoft Visual C++
- Microsoft Word
- MKS products
- Norton Utilities
- PAF
- Pagemaker
- Q & A
- Roots
- Smart Notes
- Sound Blaster
- Stacker
- TurboTax
- Corel Ventura
- XTree

North Texas Users Group, Inc.

Membership Application

The NTPCUG is a non-profit independent organization of individuals learning to apply personal computers to practical problems. For additional information, call (214) 746-4699.

Member # _____

Name: (Last) _____ (First) _____

Address: _____

City: _____ State: _____ ZIP: _____

PHONE:(Check Preferred No.) Home ____ (____) _____

Work ____ (____) _____ (Ext) _____

Occupation/Profession: _____

Check one from each column below

Payment:	Membership,	Application Status:
Cash _____	Classification:	New Member _____
Check _____	Regular (\$24.00) ____	Renewal _____
Credit Card _____	Student (\$16.00) ____	Address Change _____

Applications should be mailed to: North Texas PC Users Group, P.O. Box 780066, Dallas, TX 75378-0066 (Make checks payable to NTPCUG.)

Please initial here _____ If you do not wish to have your address included on member

North Texas PC Users Group, Inc.

P.O. Box 780066, Dallas, TX 75378-0066

Phone (214) 746-4699 for recorded information about the North Texas PC Users Group and scheduled meeting date times and locations. Please leave a message if you would like specific information about the Group.

The North Texas PC Users Group, Inc., is a non-profit, independent group, not associated with IBM or any other corporation. Membership is open to owners and others interested in exchanging ideas, information, hardware, predictions, and other items related to IBM Personal and compatible computers. To join the Group, complete the application blank printed elsewhere in

this newsletter, and send with \$24 membership dues to the Membership Director — address shown below. Subscription to the newsletter is included with each membership. The Group meets once each month, usually on the third or fourth Saturday. See inside front cover for date, time and place of the next North Texas PC Users Group meeting.



North Texas PC Users Group, Inc.

Board of Directors

Jim Hoisington, Chairman
 Reagan Andrews Timothy Carmichael
 Doug Gorrie Alex Lilley
 Andy Oliver Fred Williams

NTPCUG Bulletin Board

NOTE: To access the BBS Metro line from outside Area Code 214, use Area Code 214. (This is NOT a toll call from Fort Worth and the Mid-Cities area.)

Bulletin Board Settings: N - 8 - 1
 (No parity, 8 data bits, 1 stop bit)

NTPCUG BBS Telephone Numbers:

..... (214)387-2751
 (214)387-2752
 METRO (214)263-9036

SYSOP: Fred Williams
 Assistant Sysop: Tom Prickett
 Assistant Sysop: Doug Gorrie
 Information Mgt: Lewis Graber
 User Relations: Adam Peterson

Voice line for validation problems:
 (214)682-0725..... Ask for Adam

TI PRO BULLETIN BOARD..... (214)361-5275
 SYSOP: Tom Blackwell

NTPCUG Officers

President	Jim Hoisington	(214) 416-3101 h
President-Elect	Andy Oliver	(214) 223-4044 h
		(214) 960-4215 w
Program Chairman	Timothy Carmichael	(214) 661-4626 w
Treasurer	Raymond T. Reyes	(903) 569-2638
Secretary	John West	(214) 620-8741 h
Membership Dir.	Jim Hoisington	(214) 416-3101h
Advertising Dir.	Connie Andrews	(214) 828-0699h
(Acting)		
Publicity	JoAnn Elliott	(214) 231-5332
Disk of the Month	Jan Parkhill	(214) 828-2216 h
Volunteer Coord.	Claude McClure	(214) 867-0978 h
Bulletin Board	Fred Williams	(214) 492-1315

Members Emeritus

John Pribyl (1924 - 1993)
 Phil Chamberlain Jim Hoisington
 David McGehee Stuart Yarus
 Tom Prickett Connie Andrews
 Kathryn Loafman Reagan Andrews
 Fred Williams Timothy Carmichael

Address Changes, etc...

Payment of dues, address changes, and inquiries about membership should be directed to:

NTPCUG Membership Director
 P.O. Box 780066
 Dallas, Texas 75378-0066



North Texas PC Users Group
P.O. Box 780066
Dallas, Texas 75378-0066

Non Profit Org.
U.S. Postage Paid
Arlington, TX
Permit No. 823

Address Correction Requested

14.12

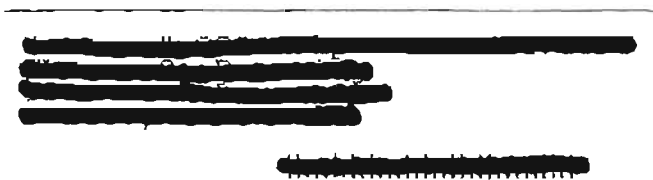

North Texas PC Users Group



Next Meeting:
16 December 1995

